

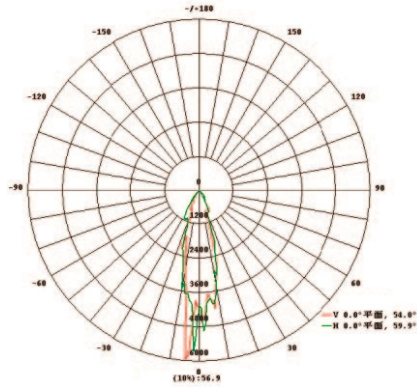

Office No: 412E, Ibn Battuta Gate Office Building, Dubai  
Tel No: +971-4-553-0601, Email: [info@korner-stone.com](mailto:info@korner-stone.com)

# SHIP SPOT LIGHT SHIP SEARCHLIGHT



**The scope of application:**

Applied to illumination of ship, port, dock, station and plaza etc.

**Products characteristic:**

1. The lampshade is transparent toughened glass, the reflector is plated by chrome with high reflection efficiency.
2. Light body can rotate for  $\pm 180^\circ$  horizontally, and pitching  $120^\circ$ .

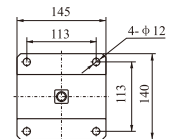
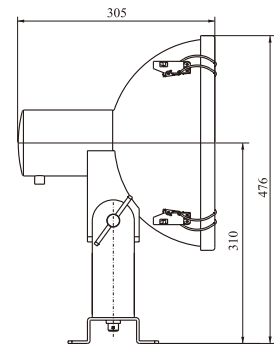
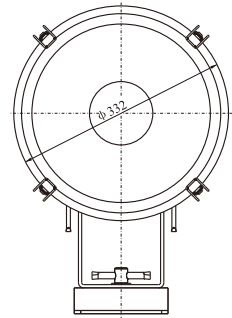

Type	TG1-A	TG1-B
Power	300W	
Weight	8kg	
Luminous flux (lm)	4610	
Voltage	DC110V/AC220V	
Lamp holder	E40	
Illuminant	Incandescent bulb	
Material	Steel	
Protection class	IP56	
Cable outside diameter	$\phi 10 - \phi 12$	
Remark	Without guard	With guard

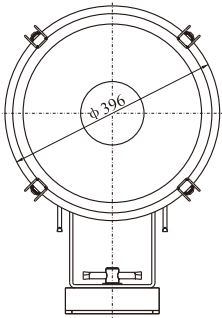
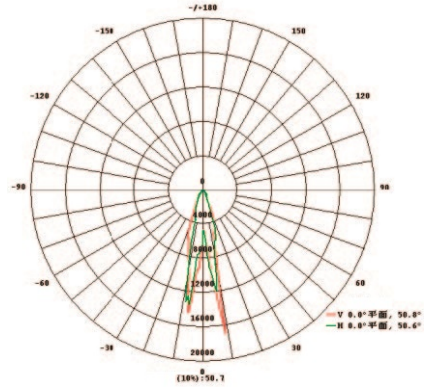

**TG2-A TG2-B**
**SPOT LIGHT**

**The scope of application**

Applied to illumination of ship, port, dock, station and plaza etc.

**Products characteristic:**

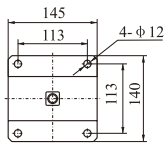
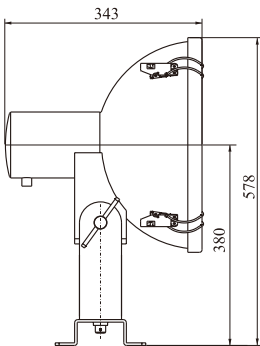
1. The lampshade is transparent toughened glass, the reflector is plated by chrome with high reflection efficiency.
2. Light body can rotate for  $\pm 180^\circ$  horizontally, and pitching  $120^\circ$ .



Type	TG2-A	TG2-B
Power	500W	
Weight	9.7kg	
Luminous flux (lm)	8300	
Voltage	DC110V/AC220V	
Lamp holder	E40	
Illuminant	Incandescent bulb	
Material	Steel	
Protection class	IP56	
Cable outside diameter	$\phi 10 - \phi 12$	
Remark	Without guard	With guard



**TG3 TG3-A**

**SPOT LIGHT**

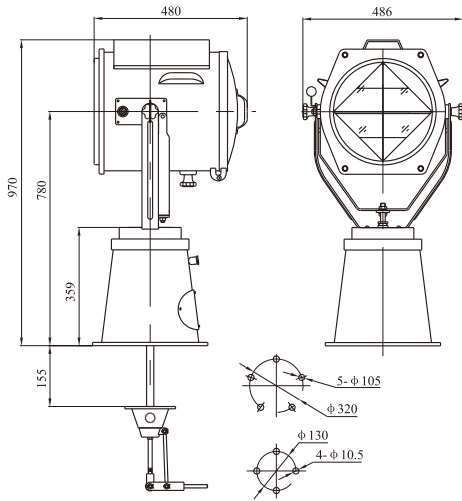

patent No.: ZL201030708941.3

**The scope of application**

Fitting for signal exchange among ships

**Products characteristic**

1. Equipped focus nut under the light shell, can adjust lighting foci.
2. Inside the light equips grid, joy stick, and can send the lighting signal according to the requirement.
3. Can rotate for ±180° horizontally, and pitching 30° by the lift-hole or controller.

Voltage: DC110V AC220V  
 Illuminant: Incandescent focus bulb  
 Power: 1000W  
 LMluminous flux: 17000  
 Lamp holder: E40  
 Protection class: IP55  
 Material: steel  
 Weight: **(TG3)** 39.2kg, **(TG3-A)** 41.5kg  
 Annex: **(TG3)** Lift-pole, **(TG3-A)** Controller

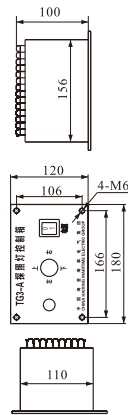
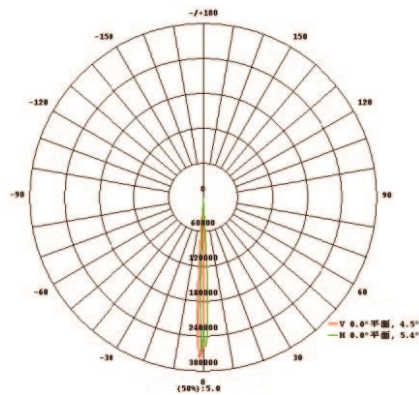
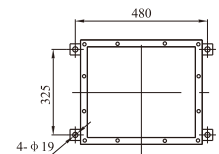
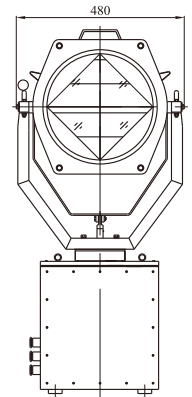
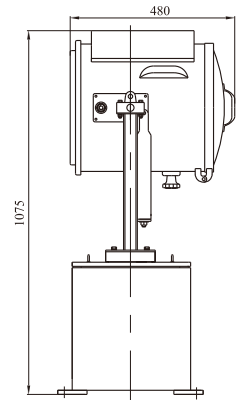

# CTG3 CTG3-A SPOT LIGHT



CTG3-A



CTG3

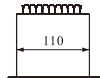
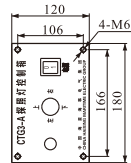
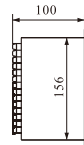
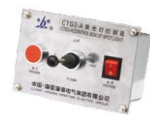
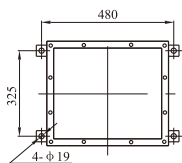
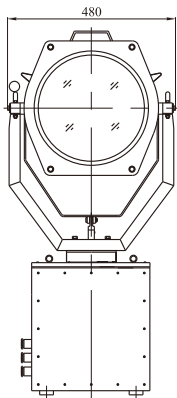
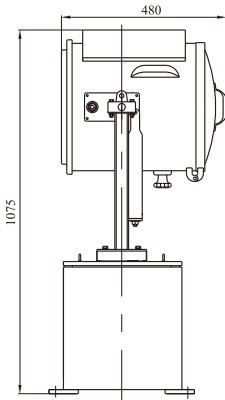
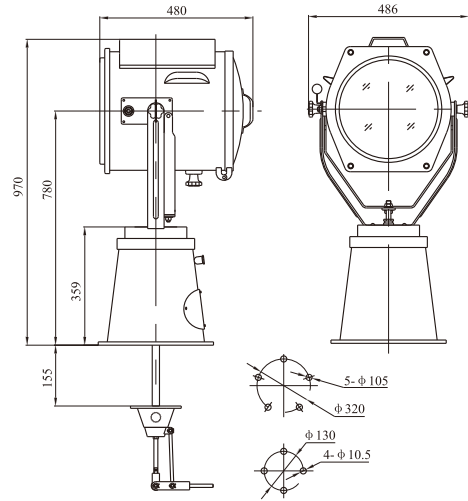

Voltage: DC110V AC220V  
 Illuminant: Incandescent focus bulb  
 Power: 1000W  
 LMuminous flux: 17000  
 Lamp holder: E40  
 Protection class: IP55  
 Material: steel  
 Weight: (TG3) 39.2kg, (TG3-A) 41.5kg  
 Annex: (TG3) Lift-pole, (TG3-A) Controller

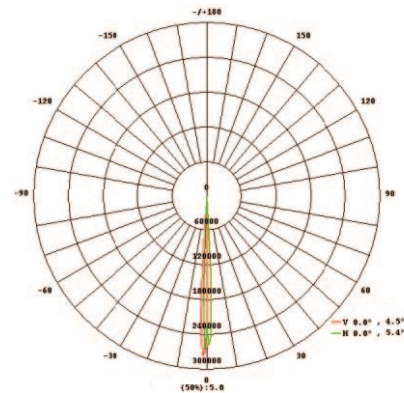

### The scope of application

Fit for large area illumination of ship, mine, wharf, building site etc.

### Products characteristic

1. Equipped focus nut under the light shell, can adjust lighting foci.
2. The lampshade is transparent safe toughened glass, sphere toughened glass reflector, can send the intensity light-beam which is concentrated.
3. The light body can rotate for  $\pm 180^\circ$  horizontally, and pitching  $30^\circ$  by the lift-hole or controller.



**SIGNAL SEARCHLIGHT** **TG3-N**

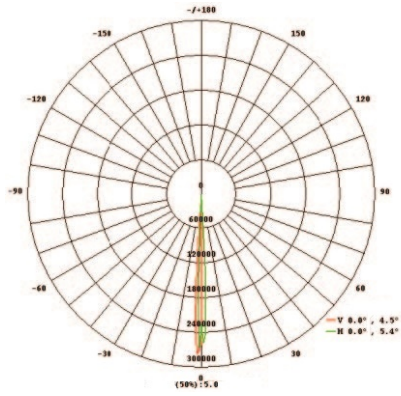

1000W



**The scope of application**

Applied to signal exchange among ships, the visibility distance is 15n.m.

**Products characteristic:**

1. Equipped focus nut under the light shell, it can adjust lighting focus.
2. Inside the light equips grid, joy stick, and can send the lighting signal according to the requirement.
3. It can rotate for 350° horizontally, and pitching 30° by the lifter rod.

Voltage	DC110V/AC220V
Power	1000W
Lamp holder	E40
Illuminant	Incandescent focus bulb
Luminous flux (lm)	17000
Material	Stainless steel
Protection class	IP56
Cable outside diameter	φ 10-φ 12
Weight	30kg
Annex	Lifter rod

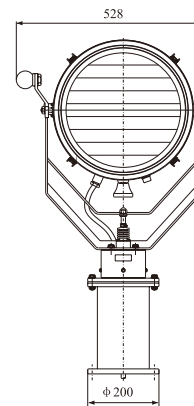
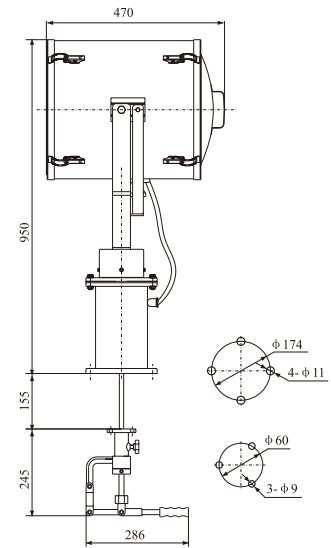

# TG3-AN

## SIGNAL SEARCHLIGHT

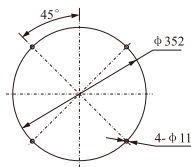
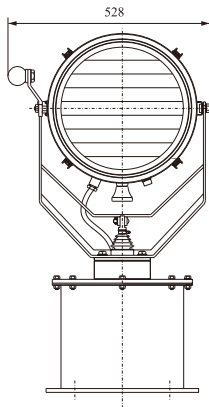
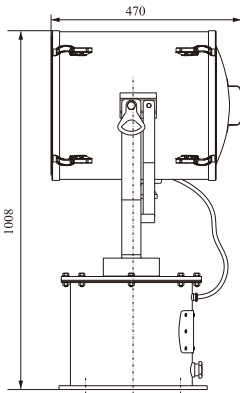
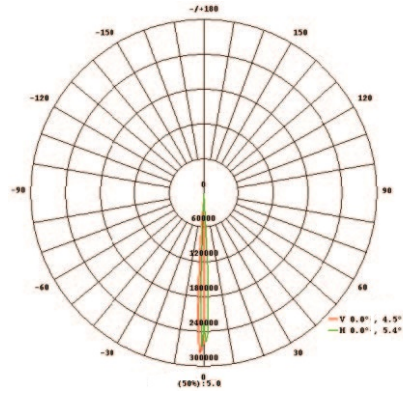

### The scope of application

Applied to signal exchange among ships, the visibility distance is 15n.m.

### Products characteristic:

1. Equipped focus nut under the light shell, it can adjust lighting focus.
2. Inside the light equips grid, joy stick, and can send the lighting signal according to the requirement.
3. It can rotate for 350° horizontally, and pitching 30° by the controller.

Voltage	DC110V/AC220V
Power	1000W
Lamp holder	E40
Illuminant	Incandescent focus bulb
Luminous flux (lm)	17000
Material	Stainless steel
Protection class	IP56
Cable outside diameter	φ 10- φ 12
Weight	80kg
Annex	Controller

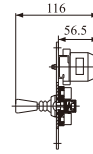
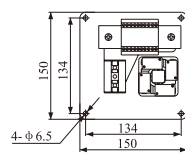

Controller mounting dimensions



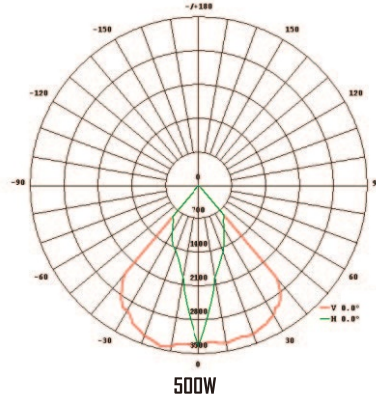
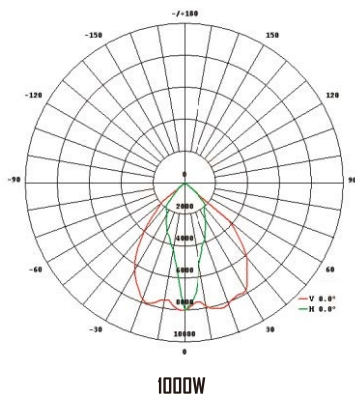

**The scope of application**

Applied to projecting illumination in outdoor place such as ship, dock, port, storeplace and petroleum platform etc.

**Products characteristic:**

1. Made of good quality stainless steel, the lampshade is made of toughened glass, and high-purity aluminum reflector, it has good reflecting effect.
2. Compact structure and beauty appearance, good seal and anticorrosive performance, adjust angle upside 90°, down 45°.

**Production authentication:**

Approved by the CCS(China Classification Society).

**Adopt standard**

1. Conform to International IEC Norm and National standard GB7000.7-2005.
2. Conform to GRADE ENTRY NORMS FOR STEEL SHIPS.

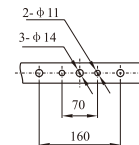
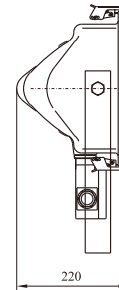
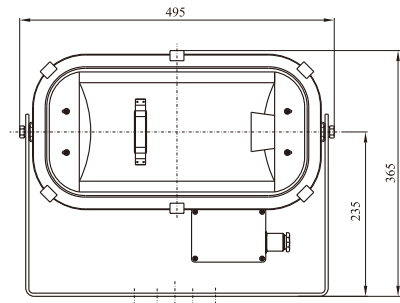

Voltage	220V/50Hz, 220V/60Hz	
Power	500W	1000W
Lamp holder	E40	
Illuminant	Tungsten halogen lamp	
Luminous flux (lm)	8500	22000
Protection class	IP67	
Cable outside diameter	φ 10- φ 12	
Weight	6kg	
Annex	Illuminant type JTT	





# TG5 TG6

## SPOT LIGHT



TG5 / TG6-XT

TG5 / TG6

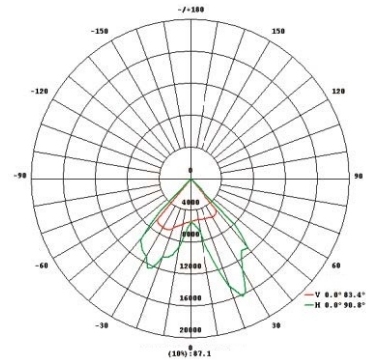

TG5 400W 钠灯HPS

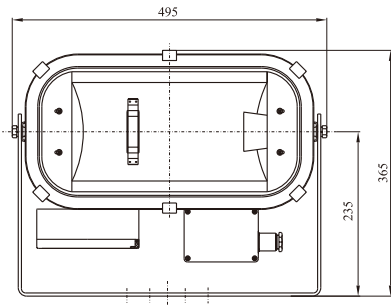
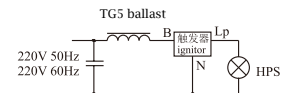
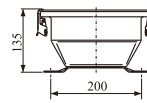
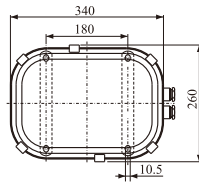

### The scope of application

Applied to projecting illumination in outdoor place such as ship, dock, port, storeplace and petroleum platform etc.

### Products characteristic:

- Made of good quality stainless steel, the lampshade is made of toughened glass, and high-purity aluminum reflector, it has good reflecting effect.
- Compact structure and beauty appearance, good seal and anticorrosive performance, adjust angle upside 90°, down 45°.

### Production authentication:

Approved by the CCS(China Classification Society).

### Adopt standard

- Conform to International IEC Norm and National standard GB7000.7-2005.
- Conform to GRADE ENTRY NORMS FOR STEEL SHIPS.

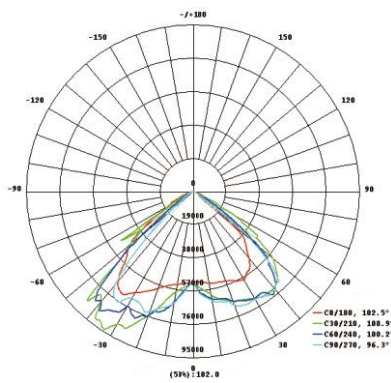
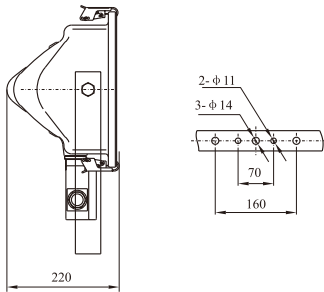

TG6 400W

Type	TG5		TG6	
Voltage	220V/50Hz, 220V/60Hz		220V/50Hz, 220V/60Hz	
Power	250W	400W	250W	400W
Lamp holder	E40			
Illuminant	High-pressure sodium lamp		Metal halide lamp	
Luminous flux (lm)	26000	47000	20500	36000
Protection class	IP67			
Cable outside Diameter	φ 10- φ 12			
Weight	8kg			
Annex	Ballast-box			



**SPOT LIGHT** **TG7 TG7-A**



TG7-A



TG7

**The scope of application**

Applied to illumination of ship, port, dock, station and plaza etc.

**Products characteristic**

1. The lampshade is transparent toughened glass, the reflector is plated by chrome with high reflection efficiency.
2. The light body can rotate for 180° horizontally, up 90° and down 45°.

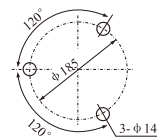
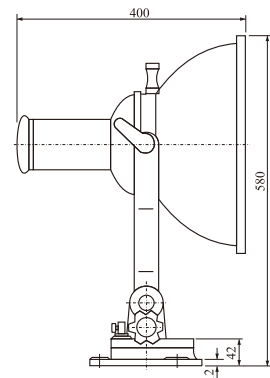

Type	TG7	TG7-A
Voltage	DC110V/AC220V	
Power	450W	
Lamp holder	E40	
Illuminant	GYZ450 Self-ballast mercury bulb	
Luminous flux (lm)	11000	
Material	Steel	Brass
Protection class	IP56	IP55
Cable outside Diameter	φ 10 - φ 12	
Weight	12.5kg	15.0kg

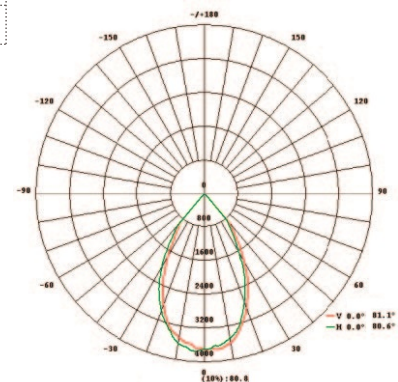

TG7 450W



**SPOT LIGHT** **TG8 TG9**

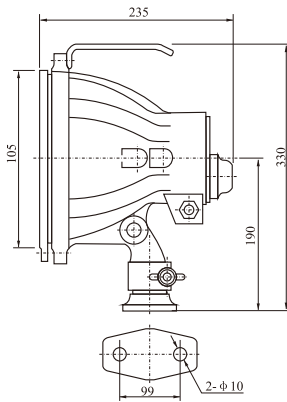

**TG8**



**TG9**

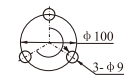
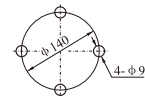
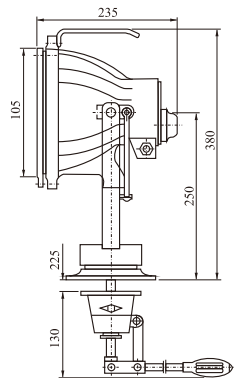

**The scope of application**

Applied to the partial illumination when searching, night navigation, lifesaving or water working for a middle or small-ship.

**Products characteristic:**

The light structure is firm, corrosive-resistant and in light weight.

Type	TG8		TG9	
Voltage	12V/24V			
Power	100W	200W	100W	200W
Lamp holder	G6.35			
Illuminant	Tungsten halogen light			
Luminous flux (lm)	2000	4500	2000	4500
Material	Aluminium			
Protection class	IP56			
Cable outside Diameter	Φ10-Φ12			
Weight	5.3kg		8.0kg	

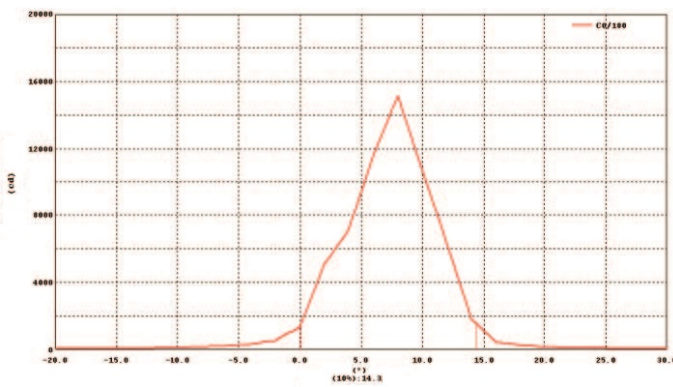

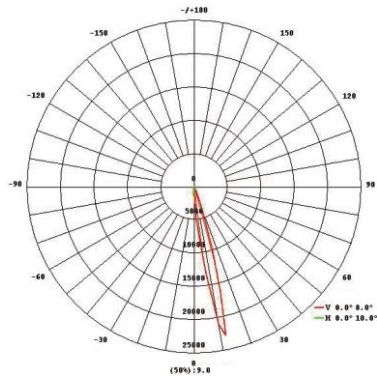

**The scope of application**

Applied to repair and warning illumination of medium and small ship, mine, wharf, oil platforms ect.

**Products characteristic:**

Small volume, easy operation, turn the horizontal 350°, Pitching 50°.

Voltage	24V / 28V
Power	450W
Illuminant	Enclosed halogentype lamp
Luminous flux (lm)	11000
Protection class	IP45
Cable outside Diameter	φ 8- φ 10
Weight	3.85kg

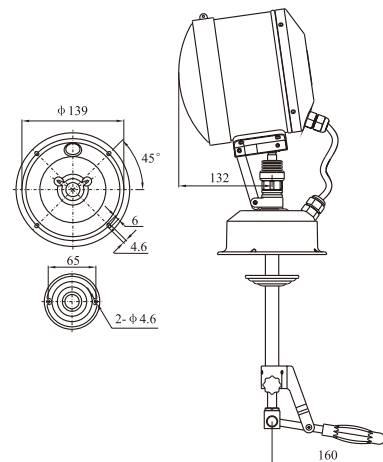
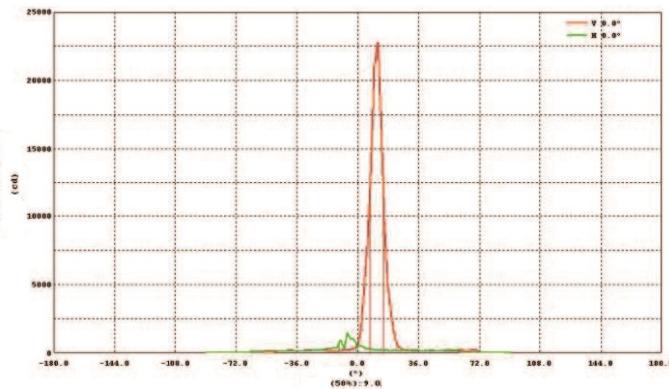
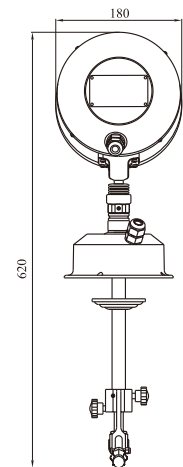

**TG11**

patent No.: ZL201030708937.7

**SPOT LIGHT**

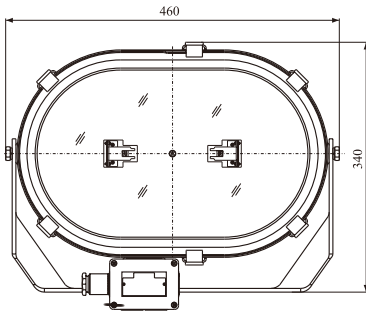
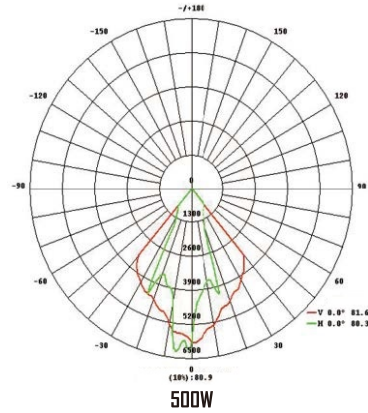

**The scope of application**

Fit for projecting illumination in outdoor place such as ship, dock port, storeplace and stadium.

**Products characteristic:**

1. Made of good stainless steel, the lampshade is made of toughened glass, and high-purity aluminum reflector, it has good reflecting effect.
2. Has compact structure and beauty appearance, small volume. Has fine seal function and anti-corrosive performance, adjust upside 90°, down 45° angle.

**Production authentication:**

Approved by the CCS(China Classification Society).

**Adopt standard**

1. Conform to International IEC Norm and National standard GB7000.7-2005.
2. Conform to GRADE ENTRY NORMS FOR STEEL SHIPS.

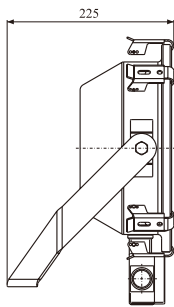

Voltage	220V/50Hz		
Power	200W	300W	500W
Luminous flux (lm)	3300	4800	8500
Lamp holder	R7s		
Protection class	IP67		
Cable outside Diameter	φ 10- φ 12		
Weight	5. 8kg		

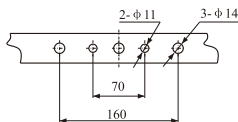

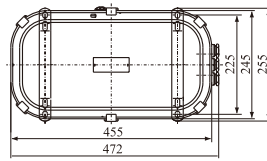
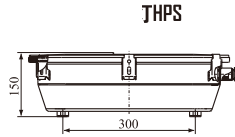
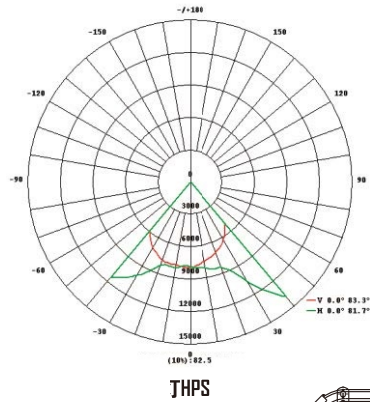

**The scope of application**

Applied to the projecting illumination of ship, dock, station, wharf construction site, storage yard, and oil platform etc ,open spale.

**Products characteristic:**

1. Made of good stainless steel ,the lampshade is made of toughened glass, and high-puriy aluminam reflector, it has good reflecting effect.
2. It has compact appearance, good seal structure and anti corrosive performance, adjust angle upside 90°, down 45°.

**Adopt standard**

Conform to International IEC Norm and National standard GB7000.7-2005.

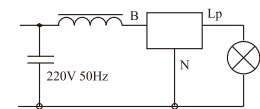
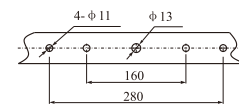
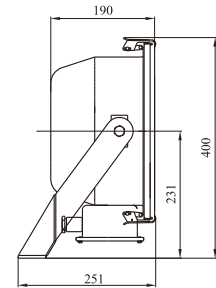
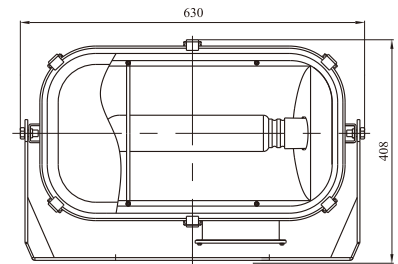

Voltage	220V/50Hz
Power	1000W
Illuminant	High pressure sodium lamp/ Metal halide lamp
Luminous flux (lm)	12000
Lamp holder	E40
Material	Stainless steel
Protection class	IP56
Cable outside diameter	Φ10-Φ12(Plastic cable gland), Φ12-Φ14(Brass cable gland)
Weight	9.25kg
Annex	Ballast box



# TG15

## SPOT LIGHT

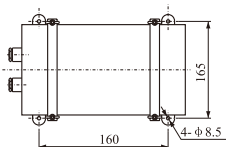
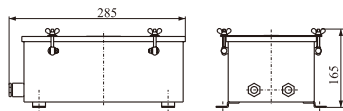
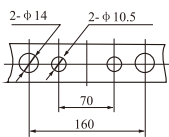
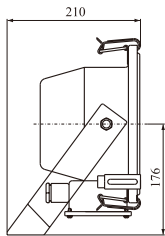
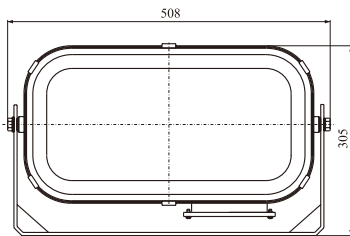
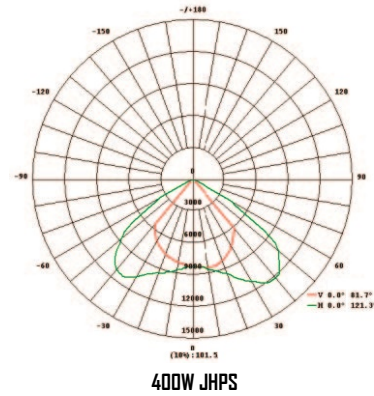

### The scope of application

Applied to illumination of ships, charf, dock, plaza and tunnel.

### Products characteristic

1. The light body adopts stainless steel, powder coat, high-purity aluminum reflector of anodic disposal, the lampshade adopts transparent toughened glass.
2. The light body has the good sealed function, intensity corrosive-resisting, the shell can adjust upside 90°, down 45°.

Voltage	110V/60Hz, 220V/50Hz, 220V/60Hz	
Power	250W	400W
Illuminant	NG250T, NG400T High-pressure sodium lamp	
Luminous flux (lm)	26000	47000
Lamp holder	E40	
Material	Stainless steel	
Protection class	IP56	
Cable outside diameter	φ 12 - φ 14	
Weight	16kg	
Annex	Ballast box	



SPOT LIGHT **TG16A TG16-B**

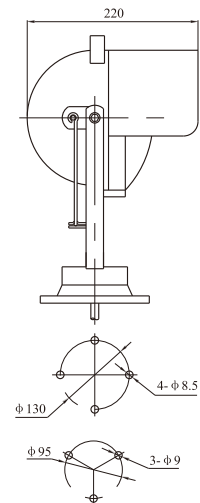
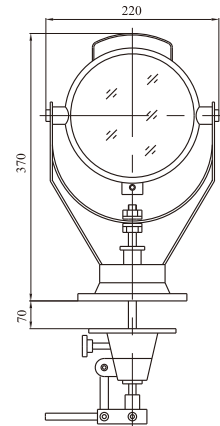
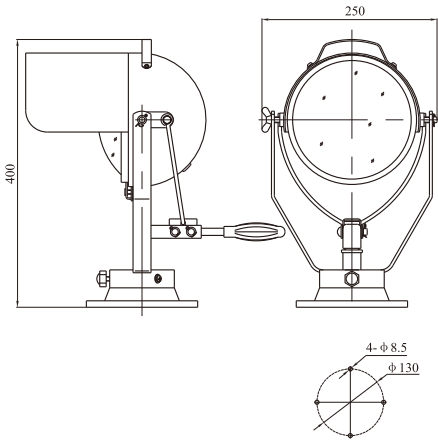

**The scope of application**

Fit for illumination of middle- or small-ship when night navigation and the repairing, warning illumination of factory mine, wharf.

**Products characteristic**

Small volume, operate agility, the shell can adjust upside 90°, down 45°.

Voltage: 12V/24V

Power: 100W

luminous flux(LM): 1600

protection class: IP45

Weight: **(TG16A)** 5.5kg, **(TG16B)** 3.0 kg





**TG19**

patent No: ZL2004 30018546.7

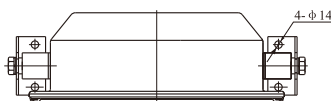
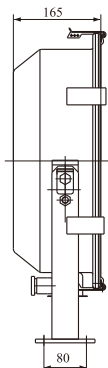
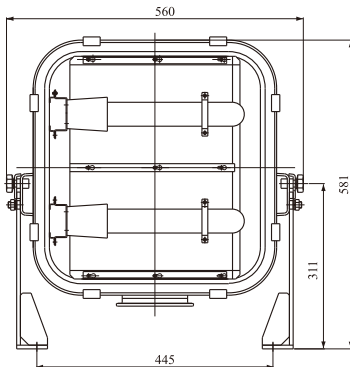
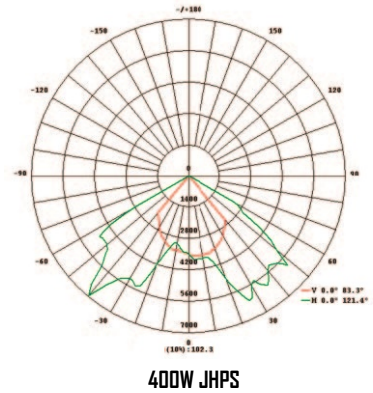
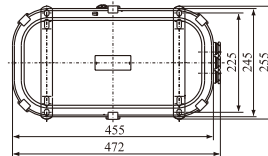
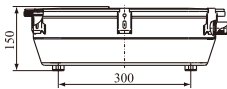
**SPOT LIGHT**

**The scope of application**

Fit for projecting illumination in outdoor place such as ship, dock port, storeplace and stadium.

**Products characteristic**

1. Made of good stainless steel, the lampshade is made of toughened glass, and high-purity aluminum reflector, it has good reflecting effect.
2. Has compact structure and beauty appearance, small volume. Has fine seal function and anti-corrosive performance, adjust upside 90°, down 45° angle.

**Production authentication**

Approved by the CCS(China Classification Society).

**Adopt standard**

1. Conform to International IEC Norm and National standard GB7000.7-2005.
2. Conform to GRADE ENTRY NORMS FOR STEEL SHIPS.

Voltage	110V/60Hz, 220V/50Hz, 220V/60Hz			
Power	2*250W	2*400W	2*250W	2*400W
Illuminant	High-pressure sodium lamp		Metal halide lamp	
Luminous flux (lm)	26000	47000	20500	36000
Lamp holder	E40			
Material	Stainless steel			
Protection class	IP56			
Cable outside diameter	φ 12- φ 14			
Weight	14.5kg			
Annex	Ballast box			



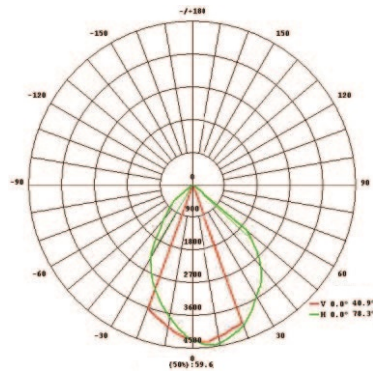

**The scope of application**

Apply to all types of vessels, docks, ports, storage yards and oil platforms and other open spaces spotlights lighting.

**Product characteristic**

1. the light has simple structure, and good water-proof function, it is applied to each places and bad surroundings.
2. It adopts good LED illumination, the working life can be over 50,000 hours. Energy saving, environmental protection, high light and uniform etc.
3. The LED starter has stabled components, to assure that the circuit has a long life time, and it has the protection for the short circuit and over load, to assure that the LED light work for long term.

**Standard adopted**

GB7000.1, GB7000.7, GB17743, GB 19510.1, GB 19510.14 etc.

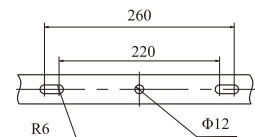
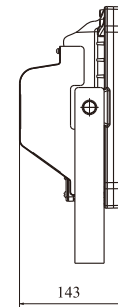
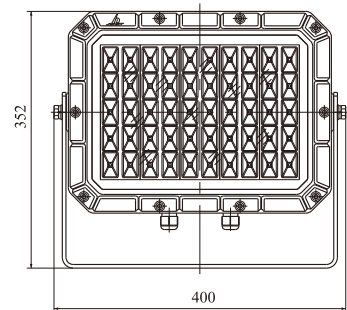

Rated voltage	AC100-240V 50/60Hz
Power	100W
Illuminant	LED
luminous flux (lm)	10000lm
ra	Ra≥85
color tempreture	5500-6500K
Protection class	IP67
Cable outside diameter	Φ9-Φ12
Weight	10Kg
installation	Fixed installation



**TG26 TG27**

patent No: ZL2003 20120669.1

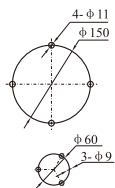
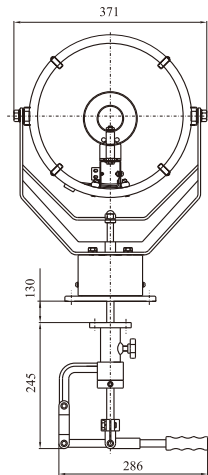
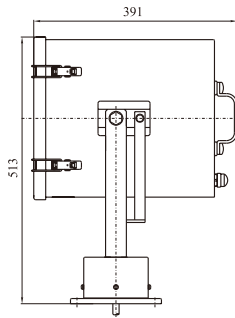
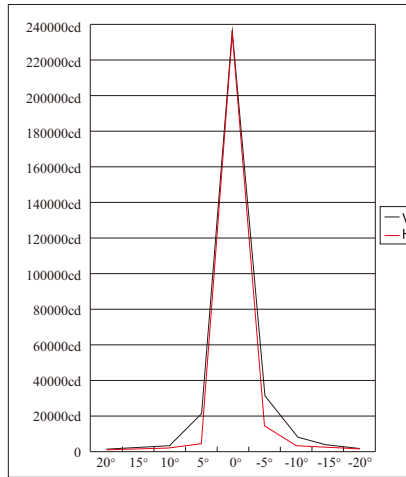
**SEARCHLIGHT**

**The scope of application**

Applied to far distance illumination and searching when night navigation, especially for illumination of sea-route and two banks and surface search when across the complex water area, such as narrow channel and the inland river riverway etc.

**Products characteristic:**

1. The lamp body and bracket is made with good quality stainless steel, toughened glass lampshade and aluminium base.
2. The lamp bend for  $\pm 30^\circ$  degrees by joy stick, adjust  $350^\circ$  degrees horizontally, equipped joy stick.
3. Parallel light-beam ,far illumination distance, concentrated light.

**Production authentication:**

Approved by the CCS(China Classification Society).

**Adopt standard**

Conform to GRADE ENTRY NORMS FOR STEEL SHIPS.

Type	TG26		TG27
Voltage	24V	220V/50Hz, 220V/60Hz	220V/50Hz, 220V/60Hz
Power	250W	300W	500W
Luminous flux (lm)	5600	6900	12500
Lamp holder	G6.35	GY9.5	GX9.5
Cable outside diameter	$\phi 10 \sim \phi 12$		
Weight	20.5kg		
Illuminant	Tungsten halogen lamp		
Protection class	IP56		



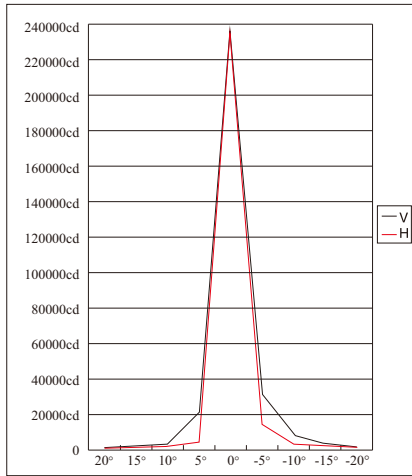

Controller mounting dimensions



**The scope of application**

Applied to far distance illumination and searching when night navigation, especially for illumination of sea-route and two banks and surface search when across the complex water area, such as narrow channel and the inland river riverway etc.

**Products characteristic**

1. The lamp body and bracket is made with good quality stainless steel, toughened glass lampshade and aluminium base.
2. The light can be adjusted up 20°, down 50° by operating box, adjust far distance of 350° horizontally, with operating box
3. Parallel light-beam ,far illumination distance, concentrated light.

**Production authentication**

Approved by the CCS(China Classification Society).

**Adopt standard**

Conform to GRADE ENTRY NORMS FOR STEEL SHIPS.

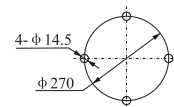
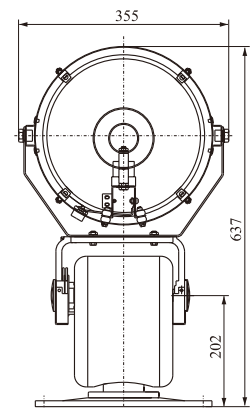
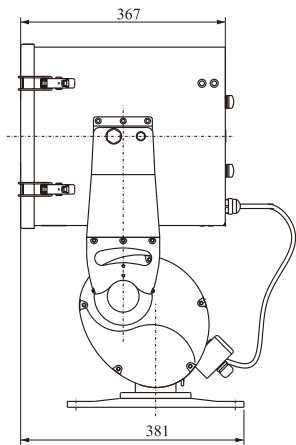

Type	TG26-A	TG27-A
Voltage	220V/50Hz, 220V/60Hz	220V/50Hz, 220V/60Hz
Power	300W      500W	1000W
Luminous flux (lm)	6900      12500	23000
Lamp holder	GY9.5	GX9.5
Cable outside diameter	φ 13~ φ 18	
Weight	24.5kg	
Illuminant	Tungsten halogen lamp	
Protection class	IP56	



**TG26-B TG27-B**

**SEARCHLIGHT**

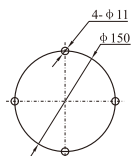
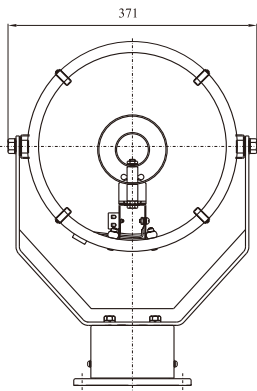
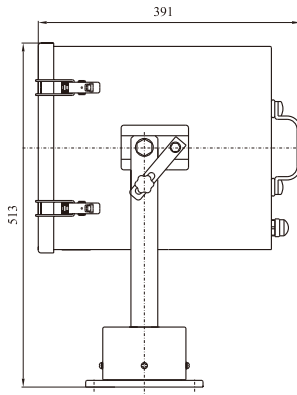
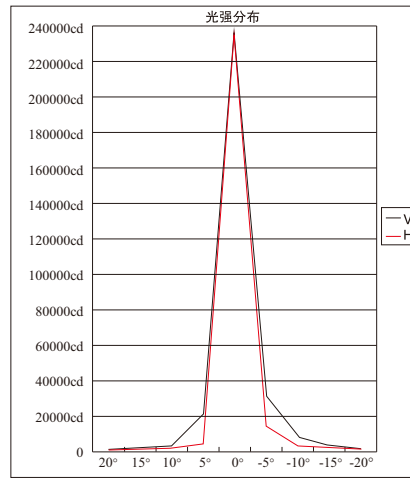

**The scope of application**

Applied to far distance illumination and searching when night navigation, especially for illumination of sea-route and two banks and surface search when across the complex water area, such as narrow channel and the inland river riverway etc.

**Products characteristic**

1. The lamp body and bracket is made with good quality stainless steel, toughened glass lamps-hade and aluminium base.
2. The lamp can adjust up 20° degrees, down 50° degrees, 350° degrees horizontally.
3. Parallel light-beam, far illumination distance, concentrated light.

**Production authentication**

Approved by the CCS(China Classification Society).

**Adopt standard**

Conform to GRADE ENTRY NORMS FOR STEEL SHIPS.

Type	TG26-B	TG27-B	
Voltage	220V/50Hz, 220V/60Hz	220V/50Hz, 220V/60Hz	
Power	300W	500W	1000W
Luminous flux (lm)	6900	12500	23000
Lamp holder	G6.35	GY9.5	GX9.5
Cable outside diameter	φ 10~ φ 12		
Weight	16.5kg		
Illuminant	Tungsten halogen lamp		
Protection class	IP56		



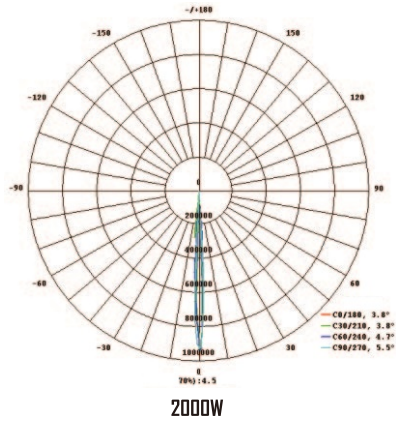

**The scope of application**

Applied to far distance illumination and searching when night navigation, especially for illumination of sea-route and two banks and surface search when across the complex water area, such as narrow channel and the inland river riverway etc.

**Products characteristic:**

1. The lamp body and bracket is made with good quality stainless steel, toughened glass lampshade and aluminium base.
2. The lamp bend for  $\pm 30^\circ$  degrees by joy stick, adjust  $350^\circ$  degrees horizontally, equipped joy stick.
3. Parallel light-beam ,far illumination distance, concentrated light.

**Production authentication:**

Approved by the CCS(China Classification Society).

**Adopt standard**

Conform to GRADE ENTRY NORMS FOR STEEL SHIPS.

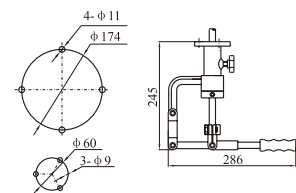
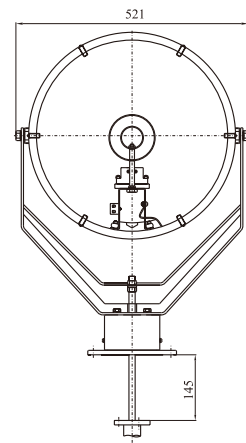
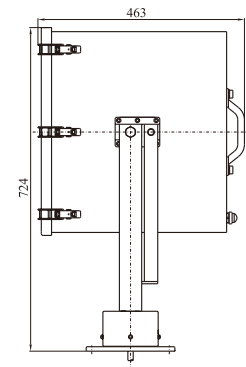

Illuminant	Tungsten halogen lamp
Protection class	IP56
Voltage	220V/50Hz, 220V/60Hz
Power	2000W
Luminous flux (lm)	53000
Lamp holder	GY16
Cable outside diameter	φ 10~ φ 12
Weight	30kg



# TG28-A

patent No.: ZL2003 3021 1968.2

## SEARCHLIGHT



Controller mounting dimensions

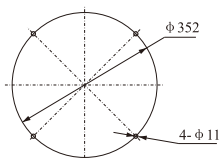
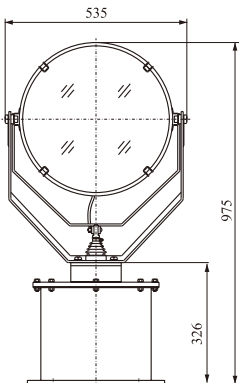
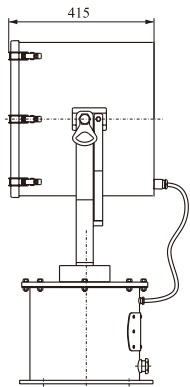
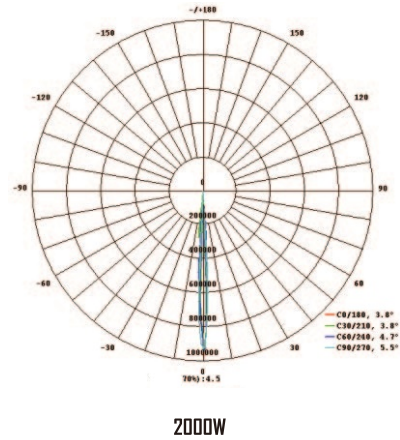
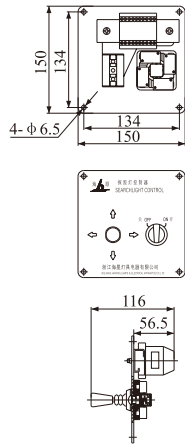

### The scope of application

Applied to far distance illumination and searching when night navigation, especially for illumination of sea-route and two banks and surface search when across the complex water area, such as narrow channel and the inland river riverway etc.

### Products characteristic

1. The lamp body and bracket is made with good quality stainless steel, toughened glass lampshade and aluminium base.
2. The light can be adjusted up 20°, down 50° by operating box, adjust far distance of 350° horizontally, with operating box
3. Parallel light-beam, far illumination distance, concentrated light.

### Production authentication

Approved by the CCS(China Classification Society).

### Adopt standard

Conform to GRADE ENTRY NORMS FOR STEEL SHIPS.

Illuminant	Tungsten halogen lamp
Protection class	IP56
Voltage	220V/50Hz, 220V/60Hz
Power	2000W
Luminous flux (lm)	53000
Lamp holder	GY16
Cable outside diameter	φ 14~ φ 16
Weight	60.5kg



**SEARCHLIGHT** **TG28-B**

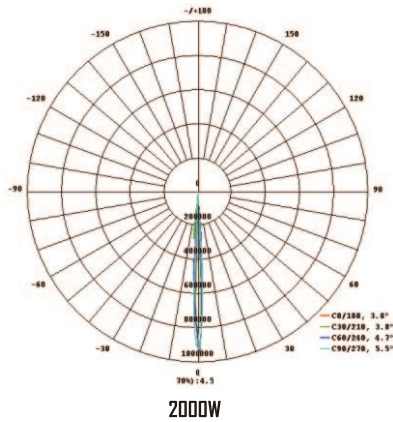

**The scope of application**

Applied to far distance illumination and searching when night navigation, especially for illumination of sea-route and two banks and surface search when across the complex water area, such as narrow channel and the inland river riverway etc.

**Products characteristic**

1. The lamp body and bracket is made with good quality stainless steel, toughened glass lampshade and aluminium base.
2. The lamp can adjust up 20° degrees, down 50° degrees, 350° degrees horizontally.
3. Parallel light-beam, far illumination distance, concentrated light.

**Production authentication**

Approved by the CCS(China Classification Society).

**Adopt standard**

Conform to GRADE ENTRY NORMS FOR STEEL SHIPS.

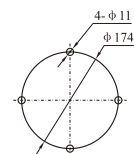
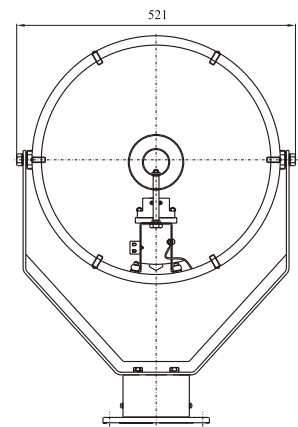
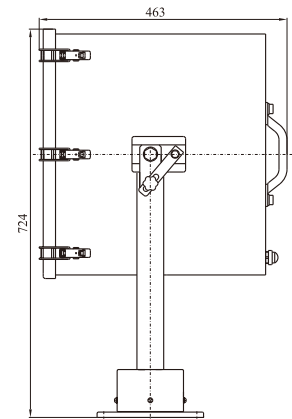

Illuminant	Tungsten halogen lamp
Protection class	IP56
Voltage	220V/50Hz, 220V/60Hz
Power	2000W
Luminous flux (lm)	53000
Lamp holder	GY16
Cable outside diameter	φ 12~ φ 14
Weight	30kg





# TZ1

## SEARCHLIGHT

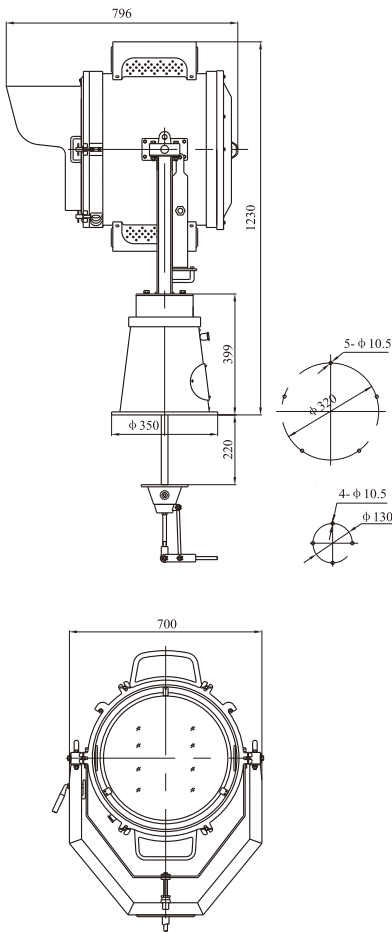
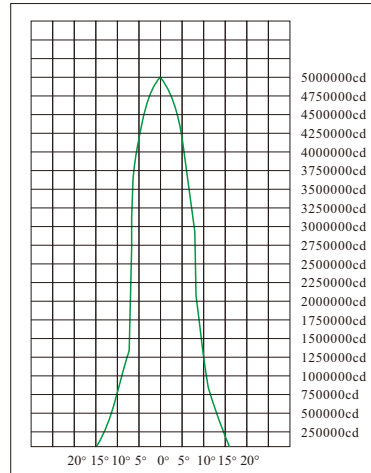
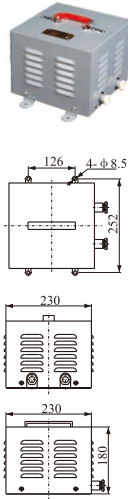

### The scope of application

Applied to remote illumination of ship night navigation, lifesaving, warning etc. and aim searching.

### Products characteristic

1. Equipped the sphere toughened glass reflector and the device of focus adjustment which can adjust the focus up and down, front and black neatly, and has the functions such as high luminous intensity , far illumination distance.
2. It is steel shell body, ball plate mounted on base, also equipped with lifting gear which can control the light body by hand to rotate for 350° horizontally And pitching 30°. Equipped the electrical box when supply DC110V, please remark clearly when order.

Voltage	DC110V, AC220V
Power	1000W
Illuminant	Sphericity mercury xenon lamp
Lumous flux (lm)	60000
Lamp holder	for special use
Protection class	IP55
Cables outside Diameter	φ 10- φ 12
Weight	58. 5kg
Annex	Ballast box, Lifter rod

Control box of mercury-xenon lamp

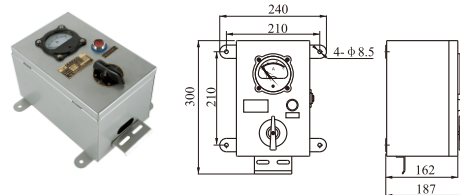

This control box is the accessory product for AC mercury-xenon searchlight TZ1, used for lighting electric control and searching at sea.



**SEARCHLIGHT** TZ1-A

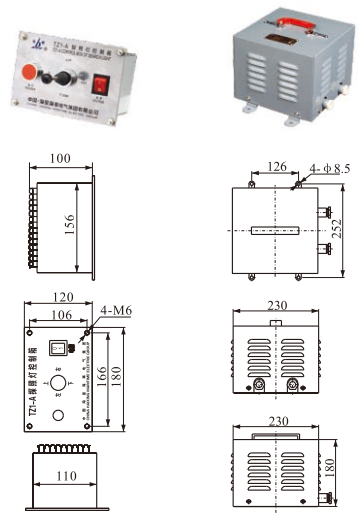
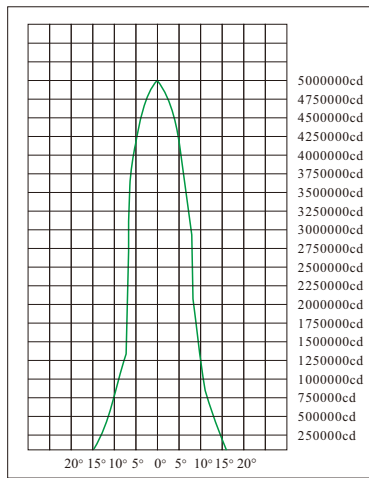

**The scope of application**

Applied to remote illumination of ship night navigation, lifesaving, warning etc. and aim searching.

**Products characteristic**

1. Equipped the sphere toughened glass reflector and the device of focus adjustment which can adjust the focus up and down, front and back neatly, and has the functions such as high luminous intensity, far illumination distance.
2. With the stainless steel shell body, a micro motor is mounted on base, and can operate the light body to rotate for 350° horizontally and pitching 30° by controller.

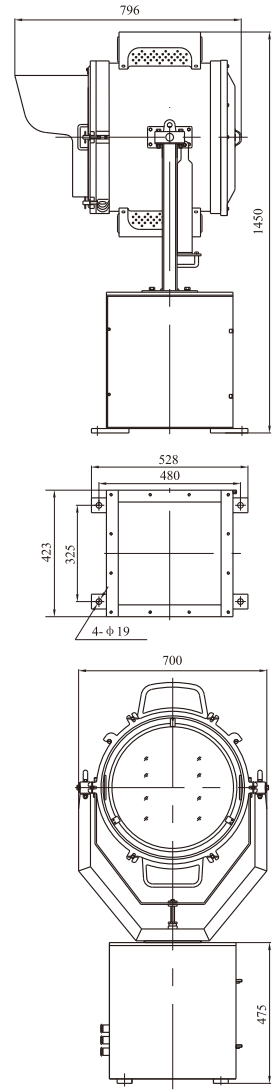

Voltage	DC110V, AC220V
Power	1000W
Illuminant	Sphericity mercury xenon lamp
Luminous flux (lm)	60000
Lamp holder	for special use
Protection class	IP55
Cables outside Diameter	φ 14- φ 16
Weight	90kg
Annex	Controller, Lifter rod



TZZ

patent No.: ZL201310215530.3

## SEARCHLIGHT (MANUAL TYPE)

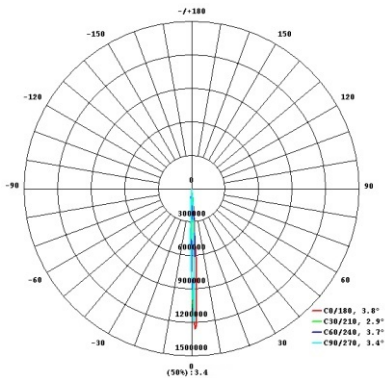
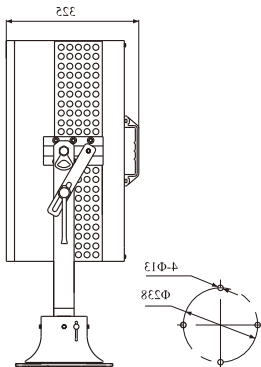
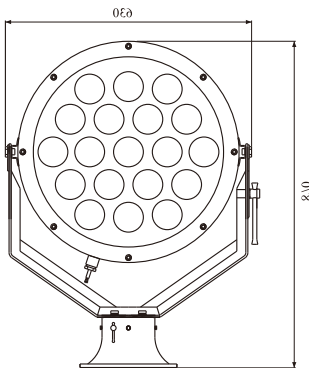

### The scope of Application

Applied to far distance illumination and searching when in night navigation, especially for illumination of sea-route and two banks and surface search when across the complex water area, such as narrow channel and the inland river way etc. It can also fit for the projecting illumination in outdoor place such as ship, dock port, store place and stadium.

### Product Characteristic

1. The light will get up to normal brightness immediately when it is on, and it will quench at once when it is turned off.
2. The lights adopts 19pcs 10W high-power LED lamp, The light power is low but the illumination distance and effect are better than 1000W Tungsten halogen lights. Irradiation distance more than 1,000 meters, Light intensity can as high as 1,200,000cd.
3. Illuminant adopts high quality illuminant, working life as long as 50,000 hours.
4. The LED starter has stabled components, to assure that the circuit has a long life time, and it has the protection for the short circuit and over load, to assure that the LED light work for long term.
5. Low-energy, High energy conservation and environmental protection, Shock-proof, anti-corrosion, water-proof, super long illuminating working life.
6. It is very convenient to replace LED bulb and LED drive power supply.
7. Light body can handle pitch by  $\pm 30$  degrees, 350 degrees horizontal automatic adjustment.

### Standard adopted

GB7000.1(IEC 60598-1)、GB7000.7(IEC 60598-2-5)、GD01 etc.

Rated voltage	AC100V~240V 50Hz/60Hz
Power	Illuminant 190W
Illuminant	LED (White)
Illuminant Lumnous flux	1900000LM
Color rendering index	$\geq 75$
Color temperture	5000-8300
Protection class	IP66
Irradiate distance	1000m
Cables outside diameter	$\Phi 9$ - $\Phi 10$
Weight	75kg About 75kg
Installs Ways	The base type



SEARCHLIGHT (AUTOMATIC TYPE)

TZ2-A

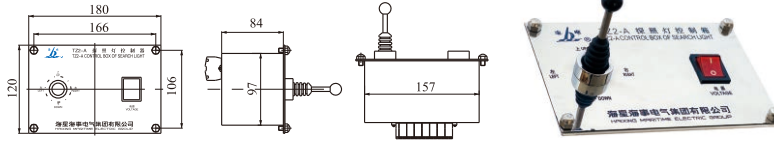

**The scope of Application**

Applied to far distance illumination and searching when in night navigation, especially for illumination of sea-route and two banks and surface search when across the complex water area, such as narrow channel and the inland river way etc. It can also fit for the projecting illumination in outdoor place such as ship, dock port, store place and stadium.

**Product Characteristic**

1. The light will get up to normal brightness immediately when it is on, and it will quench at once when it is turned off.
2. The lights adopts 19pcs 10W high-power LED lamp, The light power is low but the illumination distance and effect are better than 1000W Tungsten halogen lights. Irradiation distance more than 1,000 meters, Light intensity can as high as 1,200,000cd.
3. Illuminant adopts high quality illuminant, working life as long as 50,000 hours.
4. The LED starter has stabled components, to assure that the circuit has a long life time, and it has the protection for the short circuit and over load, to assure that the LED light work for long term.
5. Low-energy, High energy conservation and environmental protection, Shock-proof, anti-corrosion, water-proof, super long illuminant working life.
6. It is very convenient to replace LED bulb and LED drive power supply.
7. The shell can adjust the projection angle: pitching up 35 degree, down 35 degree, rote for 350 degree horizontally by controller.

**Standard adopted**

GB7000.1(IEC 60598-1), GB7000.7(IEC 60598-2-5), Gd01 etc.

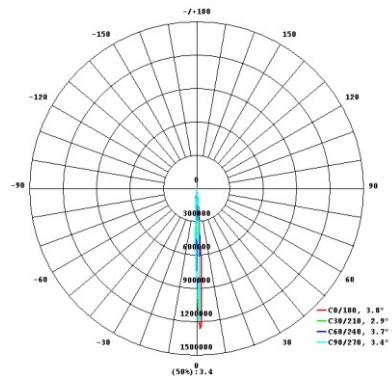
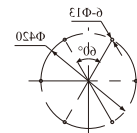
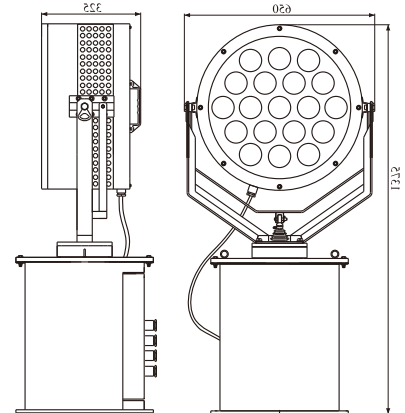

Rated voltage	AC220V 50Hz/60Hz
Power	Illuminant 190W, Electric motor 120W
Illuminant	LED (White)
Illuminant Lumnous flux	1900000LM
Color rendering index	≥75
Color tempreture	5000-8300
Protection class	IP66
Irradiate distance	1000m
Cables outside diameter	Φ12-Φ14
Weight	About 116kg
Installs Ways	The base type



**TZ5**

patent No.: ZL2006 3010 3646.9

**SUEZ CANAL SEARCHLIGHT**

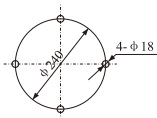
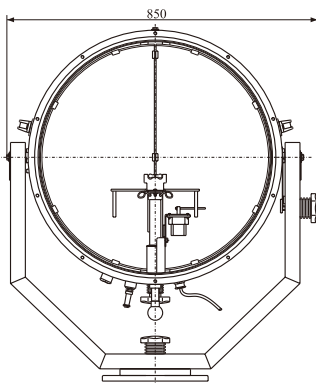
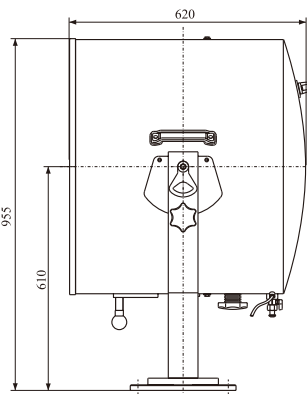
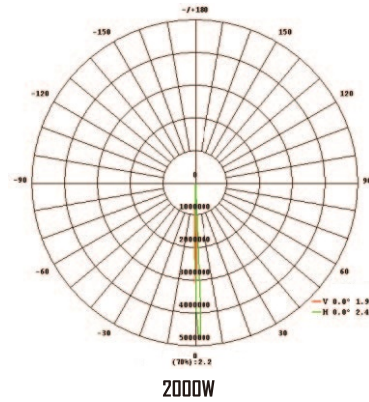

**The scope of application**

Applied to illuminations of ships over 3000.S.C.G.T. pass through the suez canal and the narrow sea-route when night navigation, can search and illuminate the obstacle on the surface.

**Products characteristic**

1. The light body adopts good quality aluminium alloy, the weight is light, good quality toughened glass lampshade
2. Design with two bulbs structure, has rotary switch inside, can change between the bulbs under the electricity.
3. Two semisphere reflector, can adjust the reflect effect between the  $\pm 5^\circ$  degrees horizontally on.
4. Equipped safe vent-valve under the lamp canister, can ensure the air pressure balance in and out the lamp canister.
5. The light can bend for  $\pm 30^\circ$  degrees, adjust  $\pm 180^\circ$  degrees horizontally.
6. Parallel light-beam ,far illumination distance.

**Adopt standard**

Conform to GRADE ENTRY NORMS FOR STEEL SHIPS  
Conform to SUEZ CANAL NAVIGATION RULES.

Voltage	220V/50Hz, 220V/60Hz
Power	3000W, 2000W
Illuminant	Tungsten halogen lamp
Lumous flux (lm)	80000 (3000W), 53000 (2000W)
lamp holder	GY16
Irradiate distance	$\geq 1800m$
Protection class	IP56
Cables outside diameter	$\phi 12-\phi 14$
Weight	29kg



**SEARCHLIGHT (MANUAL TYPE)**

**The scope of Application**

Applied to far distance illumination and searching when in night navigation, especially for illumination of sea-route and two banks and surface search when across the complex water area, such as narrow channel and the inland river way etc. It can also fit for the projecting illumination in outdoor place such as ship, dock port, store place and stadium.

**Product Characteristic**

1. The light will get up to normal brightness immediately when it is on, and it will quench at once when it is turned off.
2. The lights adopts 37pcs 10W high-power LED lamp, The light power is low but the illumination distance and effect are better than 1000W Tungsten halogen lights. Irradiation distance more than 2,000 meters, Light intensity can as high as 2,400,000cd.
3. Illuminant adopts high quality illuminant, working life as long as 50,000 hours.
4. The LED starter has stabled components, to assure that the circuit has a long life time, and it has the protection for the short circuit and over load, to assure that the LED light work for long term.
5. Low-energy, High energy conservation and environmental protection, Shock-proof, anti-corrosion, water-proof, super long illuminant working life.
6. It is very convenient to replace LED bulb and LED drive power supply.
7. Light body can handle pitch by  $\pm 30$  degrees, 350 degrees horizontal automatic adjustment.

**Standard adopted**

GB7000.1(IEC 60598-1)、GB7000.7(IEC 60598-2-5), GD01 etc.

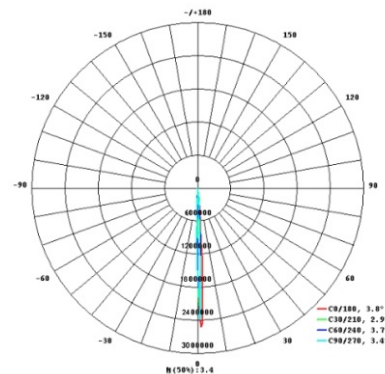
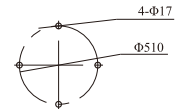
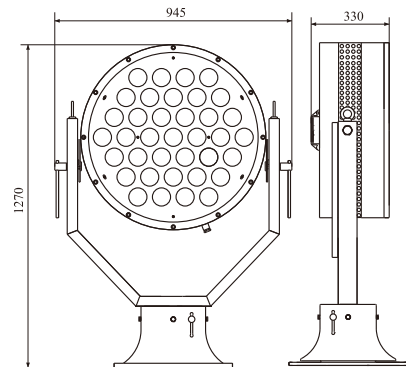

Rated voltage	AC110V~240V, 50Hz/60Hz
Power	Illuminant 370W
Illuminant	LED (White)
Illuminant lumnous flux	3700000LM
Color rendering index	$\geq 75$
color tempreture	5000-8300
Protection class	IP66
Irradiation distance	2000m
Cables outside diameter	$\Phi 9$ - $\Phi 10.5$
Weight	About 170kg
Installs Way	The base type



# TZ6-A

## SEARCHLIGHT(AUTOMATIC TYPE)

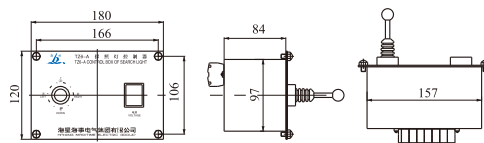

### The scope of Application

Applied to far distance illumination and searching when in night navigation, especially for illumination of sea-route and two banks and surface search when across the complex water area, such as narrow channel and the inland river way etc. It can also fit for the projecting illumination in outdoor place such as ship, dock port, store place and stadium.

### Product Characteristic

1. The light will get up to normal brightness immediately when it is on, and it will quench at once when it is turned off.
2. The lights adopts 37pcs 10W high-power LED lamp. The light power is low but the illumination distance and effect are better than 1000W Tungsten halogen lights. Irradiation distance more than 2,000 meters, Light intensity can as high as 2,400,000cd.
3. Illuminant adopts high quality illuminant, working life as long as 50,000 hours.
4. The LED starter has stabled components, to assure that the circuit has a long life time, and it has the protection for the short circuit and over load, to assure that the LED light work for long term.
5. Low-energy, High energy conservation and environmental protection, Shock-proof, anti-corrosion, water-proof, super long illuminant working life.
6. It is very convenient to replace LED bulb and LED drive power supply.
7. The shell can adjust the projection angle: pitching up 30 degree, down 30 degree, rote for 350 degree horizontally by controller.

### Standard adopted

GB7000.1(IEC 60598-1), GB7000.7(IEC 60598-2-5), GD01 etc.

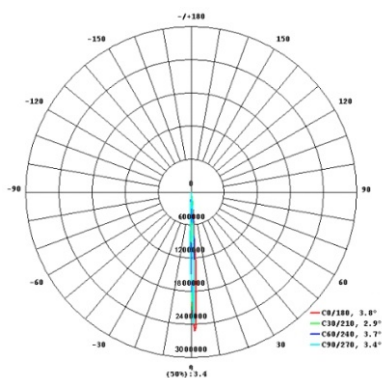
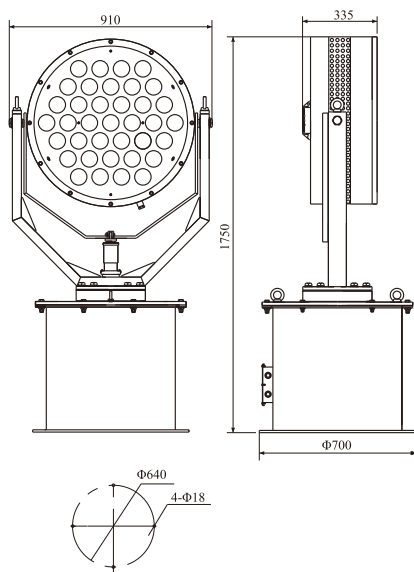

Rated voltage	AC220V,50/60Hz
Power	Illuminant 370W, Electric motor 180W
Illuminant	LED (White)
Illuminant lumnous flux	3700000LM
Color rendering index	≥75
color tempreture	5000-8300
Protection class	IP66
Irradiation distance	2000m
Cables outside diameter	Φ12-Φ14
Weight	About 275kg
Installs Way	The base type

