

# SHIP EXPLOSION-PROOF LIGHT SERIES SHIP EXPLOSION-PROOF ELECTRICAL SERIES

## The scope of application

1. Applied to the place which may accumulate the gas of inflammable and explosive and each relevant dangerous area, such as ship, petroleum platform and chemical place etc.
2. Fit for the cabin of inflammable material and explosive gas, such as the dangerous place of accumulator room, painting room, light room and liquid cargo ship.
3. Approved by the CCS(China Classification Society) and supervision and inspection type approval of national light quality, test Centre, approve by the authentication of Europe ATEX.
4. The environment electric equipment of explosive gas can divide:
  - I series: Coal mine electric equipment
  - II series: Environment electric equipment of other explosive gas except coal mine.

According to the characteristic of the explosive gas, the electric equipment of II category can divide: flameproof'd'of II category and essence safety "i",the electric equipment can divide II A, II B and II C category, the remarking II B equipment fit for the use condition of II A's equipment, the remarking II C equipment fit for the use condition of II A and II B's equipment.

The equipment classification for explosive gas

group	MICmin.ignition current	MESG ( mm) max.safe clearance
II A	$0.8 < MIC < 1.0$	$0.9 < MESG < 1.14$
II B	$0.45 < MIC < 0.8$	$0.5 < MESG < 0.9$
II C	$MIC \leq 0.45$	$MESG \leq 0.5$

The ignition temperature of explosive gas and the allowable max.surface temperature

group	°C ignition temperture	°C the allowable max.tempreture of surface
T6	$85 < T \leq 100$	85
T5	$100 < T \leq 135$	100
T4	$135 < T \leq 200$	135
T3	$200 < T \leq 300$	200
T2	$300 < T \leq 450$	300
T1	$450 < T$	450

**INCANDESCENT EXPLOSION-PROOF LIGHT**

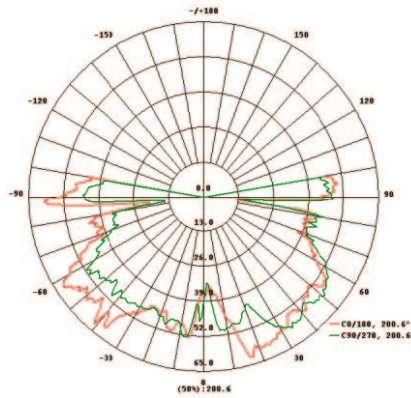

**Products characteristic**

1. The shell adopts good quality cast aluminum, toughened glass lampshade, with guard.
2. The lamp body adopts seal structure, has high waterproof performance and anticorrosive performance.

**Adopt standard**

3. Conform to GRADE ENTRY NORMS FOR STEEL SHIPS, National standard GB3836, GB12045.

Explosion-proof mark	Exd II CT4 Gb
Voltage	220V, 24V
Ambient Temperature	-20°C~+45°C
Power	≤ 100W
Illuminant	Incandescent lamp
Lamp holder	E27
Protection class	IP66
Cables outside diameter	φ 11-φ 13
Weight	2.9kg

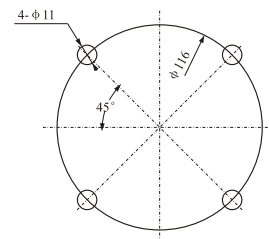
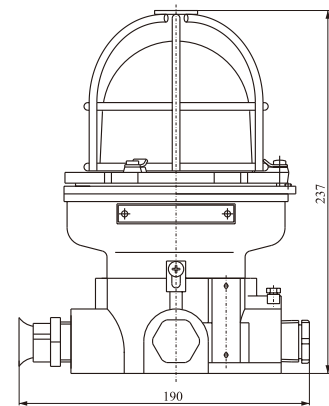

**CFD3-1**

patent No.: ZL200920199525.7

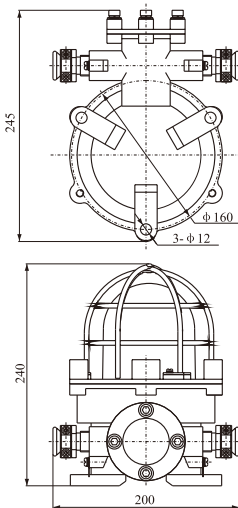
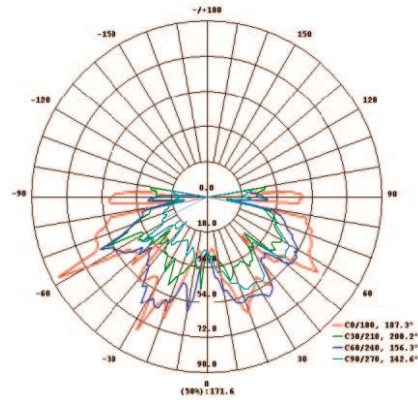
**INCANDESCENT EXPLOSION-PROOF LIGHT**

**The scope of application**

It can be used safely and reliably in the place with explosive air mixture, with explosive material II A, II B. The temperature group is T1 – T4 in cabin and outdoor place.

**Products characteristic**

1. The shell is made of good quality brass foundry, toughened glass lamp-shade, with brass guard.
2. The gland has two kind, one is tube screw type, screw is G3/4, Another one is bugle-type.

**Production authentication**

1. Passed the examination of National Explosion-proof Safety Supervision and Inspection station for Luminaire.
2. Approved by CCS(China Classification Society).

**Adopt standard**

Conform to National standard GB3836, GB12045 THE TECHNICAL CONDITION OF MARINE EXPLOSION-PROOF LIGHT.

Type	CFD3-1		
Explosion-proof mark	Exd II C T4		
Illuminant	Incandescent lamp		
Lamp holder	E27		
Protection class	IP56		
Cables outside diameter	$\phi 11 - \phi 13$		
Material	brass		
Power	25W	40W/60W	40W/60W/100W
Voltage	24V	110V	220V
Weight	8.5kg	8.5kg	8.5kg

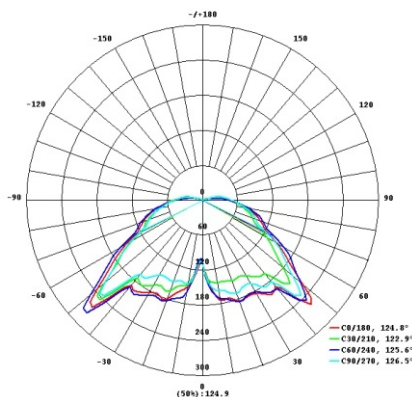

**LED EX-PROOF LIGHT**
**CFD3-L**

**The scope of application**

It can be used safely and reliably in the place with explosive air mixture, with explosive material II A, II B, II C. the temperature group is T1-T6 in cabin and outdoor place.

**Products characteristic**

1. The shell is made of good quality brass casting, toughened glass lampshade, with brass guard.
2. The gland has two kind, one is tube screw type, screw is G3/4; another is bugle-type.
3. It adopts good LED lamp, with energy-efficient, the working life can get up to 50,000 hours.
4. The LED starter has stabled components, to assure that the circuit has a long life time, and it has the protection for the short circuit and over load, to assure that the LED light work for long term.

**Standard adopted**

3836.1 ~ 3, GB12045, En50014, En50018, En60079, GB17743, GB 19510.1, GB 19510.14.

Rated voltage	AC100V~240V 50Hz/60Hz DC24V
Power	14W/3W
Explosion-proof mark	Exd II C T6 Gb
Protection class	IP66
Illuminant	LED
Cable outside diameter	Φ11 ~ Φ13
Weight	8kg

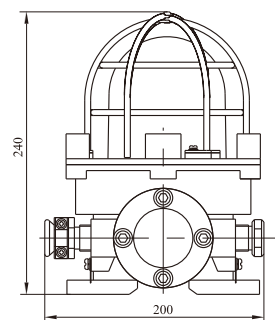
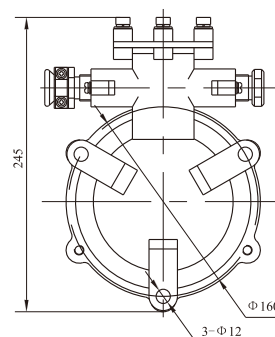

CFD4a CFD4b CFD4c

## INCANDESCENT EXPLOSION-PROOF LIGHT

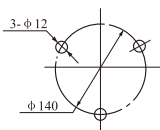
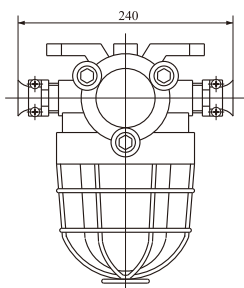
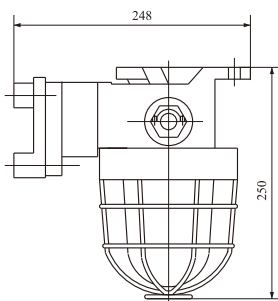
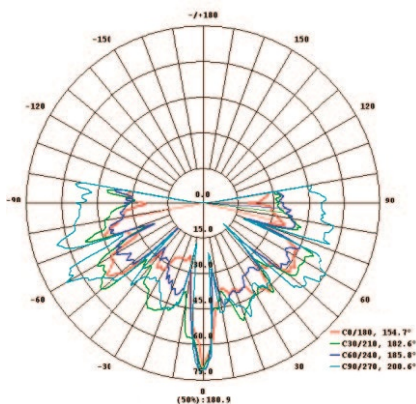

### The scope of application

Applied to the illumination in 1-2 zone dangerous places of hydric gas and air admixture, ethyne and air admixture and other flammable gas admixture.

### Products characteristic

1. The body is made of good quality brass foundry, toughened glass lamp-shade, with brass guard.
2. The gland has two kinds, one is tube screw type, screw is G3/4, Another one is bugle-type.

### Production authentication

1. Passed the examination of National Explosion-proof Safety Supervisal and Inspection station for Luminaire.
2. Appoved by CCS(China Classification Society).

### Adopt standard

Conform to National standard GB3836, GB12045 THE TECHNICAL CONDITION OF MARINE EXPLOSION-PROOF LIGHT

Type	CFD4a	CFD4b	CFD4c
Voltage	24V~220V	24V~220V	220V
Power	60W	25W	100W
Explosion-proof mark	Exd II C T4	Exd II C T6	Exd II C T3
Illuminant	Incandescent lamp		
Lamp holder	E27		
Protection class	IP66		
Cables outside diameter	φ 11 - φ 13		
Material	brass		
Weight	13kg		



EX-PROOF WINDSOCK LIGHT **CFD7-L**



**The scope of application**

The products can be installed in the hazardous area Zone 1 and zone 2, explosive gas mixture: II A、II B、II C, to indicate the wind direction for offshore Helicopter Platform, ship crane and so on, it can provide the best angle for helicopter take off and land.

**Products characteristic**

1. The shell is made of cast aluminium alloy, spraying plastics surface treatment. The light body is made with good stainless steel, with high strength and corrosion resistance.
2. It adopts good LED lamp, with high light efficiency, the working life can be over 50,000 hours.
3. The LED starter has stabled components, to assure that the circuit has a long life time, and it has the protection for the short circuit and over load, to assure that the LED light work for long term.
4. The light is with good water proof performance.
5. Wind stock is flexible rotate with the wind.

**Standard adopted**

3836.1 ~ 3, GB12045, GJB534B, GB17743, GB 19510.1, GB 19510.14.

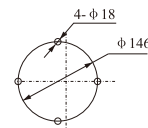
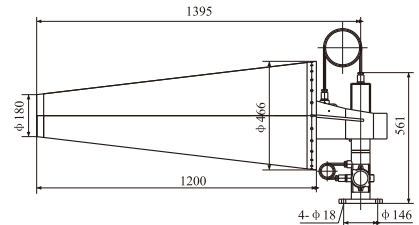

Rated voltage	AC100V~240V 50Hz/60Hz
Power	9W
Explosion-proof mark	Exde II CT6 Gb
Protection class	IP56
Illuminant	LED
Material	Stainless steel
Cables outside diameter	Φ 11 ~ Φ 13
Weight	23kg



CFD10

patent No.: ZL201230555232.5

## EX-PROOF EMERGENCY LIGHT

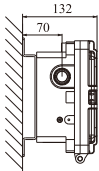
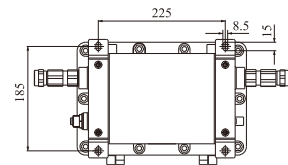
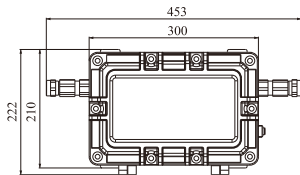

Wall-mounted

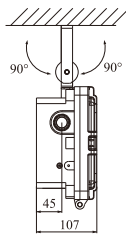
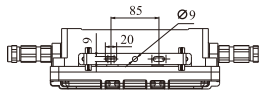
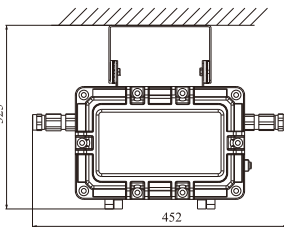

hanging

GB/T24825(IEC62384), IEC/PAS 6

**The scope of application**

This product can be used in zone 1, zone 2 for lighting function and emergency, which has the explosive gas IIA IIB,

**Product characteristics**

1. The shell is aluminum die-casting, the surface is plastic powder plated.
2. The lamp shade adopted toughened glass, which is available for the high mechanical strength and temperature changing.
3. The structure of the body is sealed, so it is strong water proof and anti-corrosion
4. The reflector adopted high purity aluminum board, surface anodized, which has accurate light distribution and high reflection.
5. Under the situation of the normal working and recharging the battery, starts power supply automatically when the electricity is cutted.
6. The light adopted maintenance-free, rechargeable battery pack, emergency time for 180 mins
7. Adopted good quality LED illuminant, which has high light efficiency, and RA, and it works for over 50000 hours
8. The LED starter has stabled components, to assure that the circuit has a long life time, and it has the protection for the short circuit and over load, to assure that the LED light work for long term.

**Adopted standard**

GB7000.1(IEC60598-1), GB7000.2(IEC60598-2-22), EN50014, GB3836.1 (IEC60079-0), GB12045, GB17945, EN60079, GB24819(IEC 62031), GB/T24824(CIE 127), GB/T24825(IEC62384), IEC/PAS 62722-2-1 etc.

Rated voltage	AC100V~240V 50/60HZ
Power	3W (Emergency lamp), 8W(Normal lamp)
Illuminant	LED
ex marks	Ex d II B T6 Gb
emergency time	≥180min
ra	Ra≥85
color temperture	5700-6500k
Protection class	IP56
Cables outside diameter	Φ11 ~ Φ13
Weight	6.5Kg
instillation	Wall-mounted hanging



**LED INCANDESCENT EXPLOSION-PROOF LIGHT**

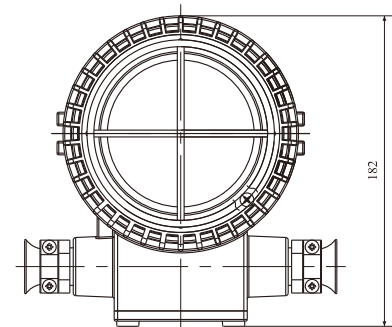
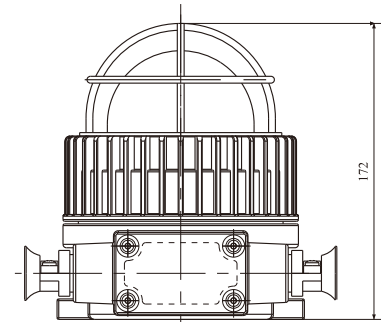

**The scope of application**

The light used for zone 1, zone 2 dangerous place, explosive air mixture: II A, II B, II C, as the illumination of platform boundary light and vessel deck.

**Products characteristic**

1. The shell adopt good quality cast brass alloy material, with spraying plastics on surface.
2. The outside tighten screw is stainless steel material.
3. The lampshade has the function of temperature resistance shake up.
4. The illumination adopt LED, the working life can get up to 50000 hours.
5. The light emitting color: red, yellow, blue, white.
6. The LED starter has stabled components, to assure that the circuit has a long life time, and it has the protection for the short circuit and over load, to assure that the LED light work for long term.

**Standard adopted**

GB 7000.1(IEC 60598-1), GB 7000.10(IEC 60598-2-1), GB 17743(CISPR15), GB 3836.1(IEC 60079-0),etc

Rated voltage	AC100V ~ 240V 50/60Hz DC24V
Power	9W
Illuminant	LED
visible	3n.m (Yellow, red, White), 1n.m (Blue)
Protection class	IP66
Cable outside Diameter	Φ11~Φ13
Weight	2.67kg
Explosion proof mark	Exde II C T6 Gb





## CFD13

## EX-PROOF PLATFORM FLOOD LIGHT

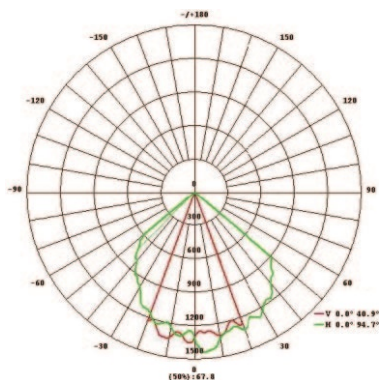
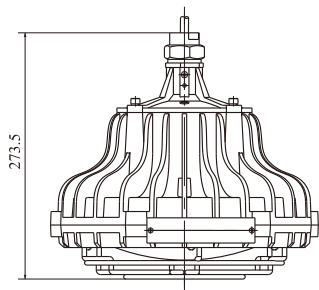
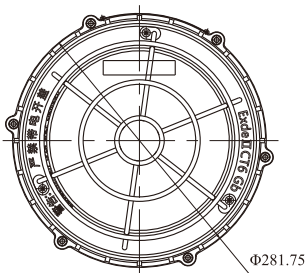
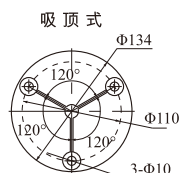
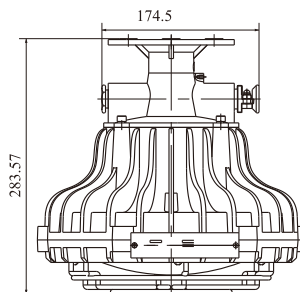

### The scope of application

Provide the illumination for the passage in the flammable or explosive or sea oil platform.

### Product characteristics

1. the light has simple structure, and good water-proof function, it is applied to each places and bad surroundings.
2. adopted good quality LED illuminant, which has high light efficiency, and RA, and it works for over 50000 hours
3. The led starter has stabled components, to assure that the circuit has a long life time, and it has the protection for the short circuit and over load, to assure that the LED light work for long term.

### Adopted standard

GB 7000.1(IEC 60598-1)、GB 7000.7(IEC 60598-2-5)、GB 3836.1~3、GB12045、En50014、En50018、En60079、GB17743、GB19510.1、GB19510.14

Rated voltage	AC100-240V 50/60Hz
Power	50W
Explosion-proof mark	Exde II CT6Gb
Illuminant	LED
luminous flux	5000lm
ra	Ra≥85
color tempreture	5000K
Protection class	IP66
Cables outside diameter	Φ9-Φ12
Weight	7.5Kg
instillation	Pendant type/ ceiling type



**EXPLOSION-PROOF FLUORESENT LIGHT**



	L	L1
CFY20	775	556
CFY30	1080	861
CFY40	1385	1166

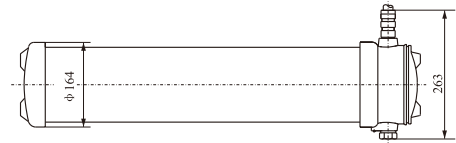
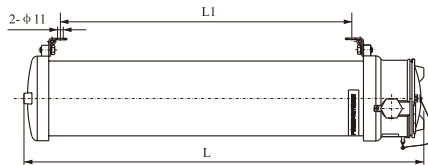

**Products characteristic**

1. The body adopts good quality stainless steel, good quality PC lampshade, with two glands, adopt fluorescent lamp.
2. The light adopts hang-type installation, and it is convenient to replace the light-tube ect
3. The light body adopts seal structure, has high waterproof performance and anticorrosion performance.

**Adopt standard**

Conform to GRADE ENTRY NORMS FOR STEEL SHIPS and national standard GB3836,

GB12045, EN50014, EN50018, EN60079.

Type	CFY20-2	CFY20-1	CFY30-2	CFY30-1	CFY40-2	CFY40-1
Power	2 × 20W	1 × 20W	2 × 30W	1 × 30W	2 × 40W	1 × 40W
Explosion-proof mark	Exd II CT6					
Voltage	220V/50Hz, 220V/60Hz, 110V/60Hz					
Lamp holder	G13					
Protection class	IP56					
Cable outside Diameter	φ 13- φ 14					
Weight	11.5kg	11.5kg	13.5kg	13.5kg	15kg	15kg

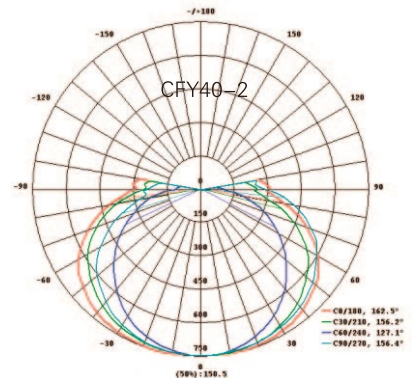

**CFY21-2 CFY41-2**

patent No.: ZL201130342663.9

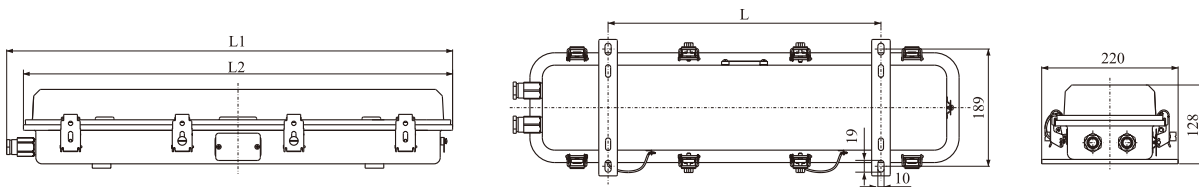
**EXPLOSION-PROOF FLUORESENT PENDANT LIGHT**

	L	L1	L2
CFY21•2	440	719	692
CFY41•2	800	1323	1294

**The scope of application**

Applied to ship oil exploit platform, chemical product and explosiv gas place zone1 or zone 2.

**Products characteristic**

1. The body is made of good quality steel, the lampshade is good quality transperence PC.
2. Intergral type clip, high protection grade.
3. The light adopts rapid ex-proof electronic ballast, with good starter effect.
4. Flameproof type, increased safety type and cementing type structure.

**Adopt standard**

conform to international IEC standard, GB19510.4, GB3836 and GB12045 standard relative requirement.

Type	CFY21-2	CFY41-2
Power	2*20W	2*40W
Explosion-proof mark	Exemd II C T5	
Voltage	220V/50Hz, 220V/60Hz, 110V/60Hz	
Lamp holder	Fa6	
Protection class	IP56	
Cable outside Diameter	φ 10- φ 12.5	
Weight	5.5kg	9.5kg

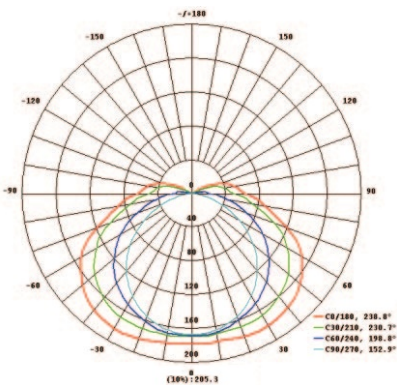

**EX-PROOF EXIT LIGHT**



**The scope of application**

Applied to exit and channel indication on explosive gas Zone 1 and Zone 2 on ship channel, emergency exit.

**Products characteristic**

1. The shell adopts quality cast aluminum alloy molding, in-built with quality toughen glass lamp shade, the signs adopts PC material printing with nice transmitting.
2. The lamp body is sealed structure, with high water proof performance and corrosion resistance.
3. The light is made with quality LED lamp, and it brings emergency equipment with transfer in 0.5 second. And it can emergency work for 180 minutes, the lamp life can be up to 50,000 hours.
4. The LED starter has stabled components, to assure that the circuit has a long life time, and it has the protection for the short circuit and over load, to assure that the LED light work for long term.

**Standard adopted**

3836.1 ~ 2, GB17945, En50014, En50018, En60079, GB17743, GB 19510.1, GB 19510.14, GB12045.

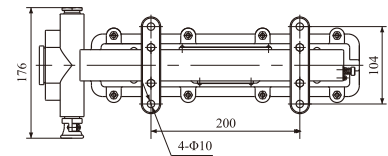
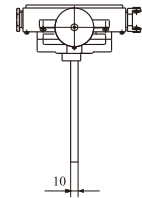
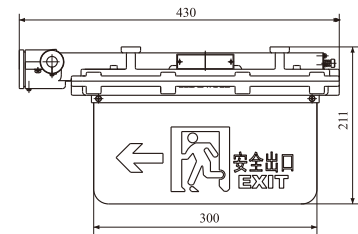

Rated voltage	AC100V 60Hz, 240V 50Hz/60Hz
Power	2W
Explosion-proof mark	Exd II CT6Gb
Protection class	IP66
Illuminant	LED
Cable outside Diameter	Φ10 ~ Φ12
Color	Green
Weight	3.4kg
Emergency time	180min
Emergency response time	≤0.5秒 Second



**CFT1-N**

patent No.: 20123055215.1

**EXPLOSION-PROOF FLOOD LIGHT**

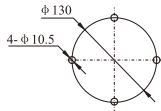
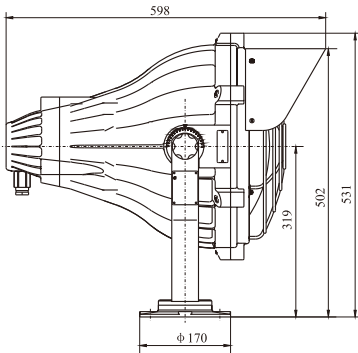

**The scope of application**

The scope of application: Applied to the explosive gas place zone 1 zone 2 with the temperature group T1-T4, also suitable for remote illumination.

**Products characteristic**

Good quality aluminium shell, brass guard and toughened glass. The light body can rotate 350° degrees horizontally and 45° degrees pitching.

**Production authentication**

1. Passed the examination of National Explosion-proof Safety Supervision and Inspection station for Luminaire.
2. Approved by CCS(China Classification Society).

**Adopt standard**

Conform to National standard GB3836, GB12045 THE TECHNICAL CONDITION OF MARINE EXPLOSION-PROOF LIGHT.

Voltage	220V/50Hz, 220V/60Hz		
Power	300W	400W	450W
Illuminant	Incandescent lamp	High pressure mercury lamp	Self-ballast mercury lamp
Explosion-proof mark	Exd II B T3		
Lamp holder	E40		
Protection class	IP56		
Material	铝 Aluminium		
Cable outside Diameter	φ 12- φ 14.5		
Weight	10kg		
Annex		Ballast	

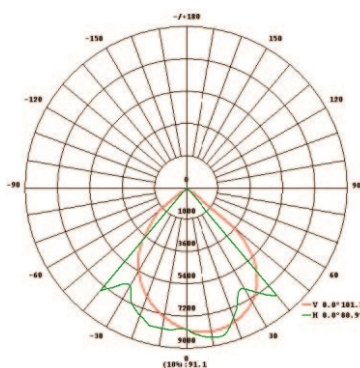
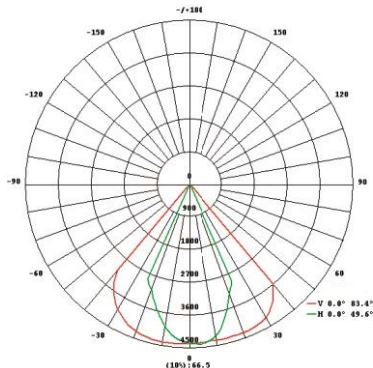
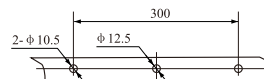
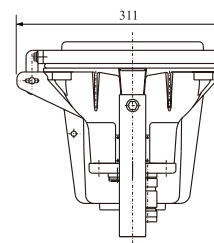
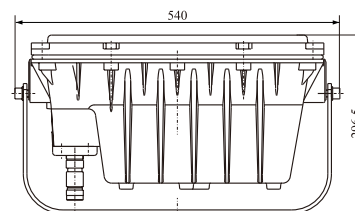

**EXPLOSION-PROOF SPOT LIGHT**

**CFT2 400W JHPS**

**CFT2 400W  
400W metal halide**

**Products characteristic**

1. The body adopts good quality cast aluminium, good quality toughened glass lampshade, The light body can adjust pitching 45° degrees.
2. The light body adopts seal structure, has high waterproof performance and anticorrosive performance.
3. Equipped ballast inside, no need to equipped ballast box (except the voltage is 110V/60Hz).

**Adopt standard**

Conform to GRADE ENTRY NORMS FOR STEEL SHIPS and National standard GB3836, GB12045, EN50014, EN50018, EN60079.

Voltage	220V/50Hz, 220V/60Hz, 110V/60Hz			
Illuminant	High pressure sodium lamp	Metal halide lamp	High pressure sodium lamp	Metal halide lamp
Power	250W	250W	400W	400W
Luminous flux (lm)	26000	20500	47000	36000
Explosion-proof mark	Exde II BT3	Exde II BT3	Exde II BT2	Exde II BT2
Lamp holder	E40			
Protection class	IP56			
Cable outside Diameter	φ 13– φ 14			
Weight	24.5kg			

**CFT3**

patent No.: ZL201020698795.5

**EXPLOSION-PROOF SPOT LIGHT**

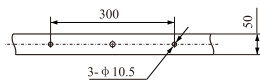
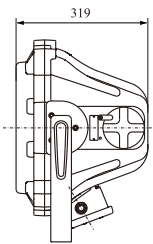
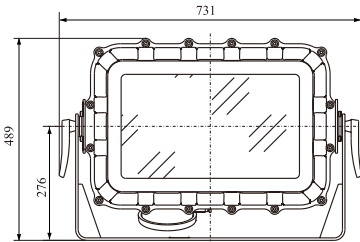
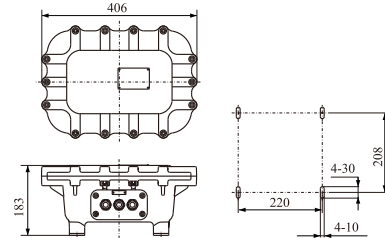

**The scope of application**

Applied to illumination of explosive gas place Zone 1 or zone 2

**Products characteristic**

1. The light body and ballast box is divided-body design, it has the function of compact structure and ensure explosion proof.
2. The light can adjust vertical  $\pm 45^\circ$ .
3. The body adopt high intensity aluminum alloy material, it has the ability of high collision proof and shock proof.
4. The transparent part adopt aluminum alloy, it can bear high machinery strength and temperature change.
5. The reflector adopt high purity aluminum plate, the surface through anodizing treatment and through exact light distribution design good effect of reflector.
6. Pay attention EXB1 is CFT3 special electric box, CFT3 ex-proof spot light and EXB1 ballast box must match to use.

**Adopt standard**

Conform to National standard GB3836.1 ~ 3, GB12045, GB7000.7.

Model	CFT3				EXB1
Voltage	220V/50Hz 220V/60Hz				110V/220V
Power	400W	400W	1000W	1000W	Max1000W
Illuminant	High pressure sodium lamp	Metal halide lamp	High pressure sodium lamp	Metal halide lamp	
Explosion-proof mark	Exde II BT4	Exde II BT4	Exde II BT3	Exde II BT3	Exde II BT5
Luminous flux (lm)	47000	36000	120000	120000	
Lamp holder	E40				
Protection class	IP56				
Cable outside Diameter	$\phi 11 - \phi 13$				
Weight	49.5kg(CFT3), 22kg(EXB1)				



EXPLOSION-PROOF SPOT LIGHT **CFT6-L**



**Application scope**

Applied to all kinds of explosion-proof required ship, dock, port, store place, oil platform and stadium for illumination. It can be safely and reliably used in place of explosive air mixture II A, II B, II C, temperature level T1 ~ T6.

**Product characteristics**

1. The light can be used in explosion-proof environment, with high explosion-proof and wide application scope.
2. The body adopts casting aerial aluminum alloy, spraying plastic on the surface.
3. The lampshade is made of toughened glass, with good mechanical and chemical performance.
4. The light can be adjusted up and down flexibly.
5. The light has high performance of waterproof and anticorrosion.
6. Adopt high quality LED illuminant with high lighting efficiency and working life over 50,000 hours.
7. The LED starter has stable components, to ensure that the circuit has a long life time, and it has circuit protection for short circuit and overload, to ensure the LED light work for long term.

**Standards**

Conform to GB 7000.1-2007、GB7000.1-2007、GB7000.7-2005、GB 3836.1-2010

Rated Voltage	AC100-240V 50Hz/60Hz
Power	100W
Illuminant	LED
Luminous flux	10000lm
Color temperature	5000K
Ra	Ra≥85
Explosion-proof mark	Ex d II C T6 Gb
Cable outside Diameter	φ 10- φ 12
Protection class	IP66

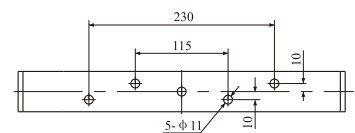
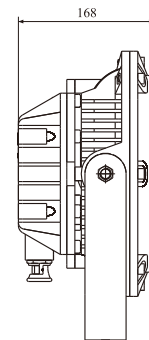
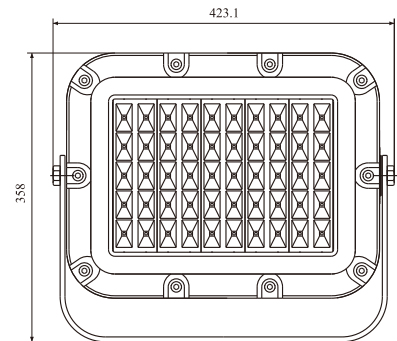

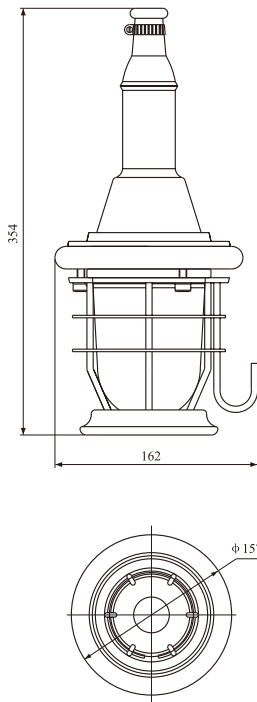

**EXPLOSION-PROOF PORTABLE LIGHT**

**Products characteristic**

1. The handle adopts good quality rubber, good quality toughened glass lampshade, with guard.
2. The light body adopts seal structure, has high waterproof performance and anticorrosive performance, fit for illuminating temporary work place used for checking and repairing ship or loading or unloading goods.

**Adopt standard**

Conform to GRADE ENTRY NORMS FOR STEEL SHIPS. and National standard GB3836, GB12045, EN50014, EN50018, EN60079.

Model	3233
Explosion-proof mark	Exed II AT2
Voltage	220V, 24V
Power	60W
Illuminant	Incandescent lamp
Lamp holder	E27
Protection class	IP56
Cable outside Diameter	$\phi 8 - \phi 10$
Weight	2.7kg



EXPLOSION-PROOF PORTABLE LIGHT

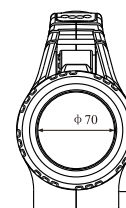
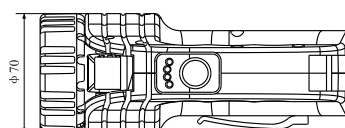
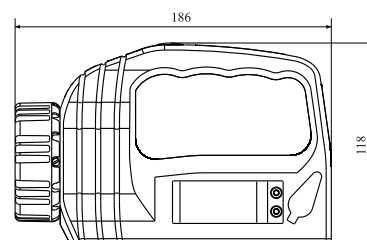

**Application scope**

Applied to ships and ports; illumination in explosive gas area Zone 1 or Zone 2.

**Product characteristics**

1. The body of light is made of aluminum die casting molding.
2. The lampshade adopts toughened glass, with heat resistance and high light transmittance.
3. The reflector adopts high quality injection molded PC, using high-tech surface treatment process, with high reflective efficiency and uniform light color.
4. Illuminating intensity can be adjusted according to the requirement.
5. Illumination angles can be rotated up and down within a range of 120 degrees.
6. The light source adopts solid-state LED of high power, high brightness, high luminous efficiency, and long service life, which can achieve the effect of maintenance-free by low calorific value, low working current, good explosion-proof performance and long working life.
7. It has the advantage of high energy battery without memory, large capacity, non-pollution, long service life, excellent charge and discharge performance, and low self-discharge rate; On the basis of the lighting function, it also strengthen the function of flash frequency to make a remote signal indicator.
8. Precise structure design, excellent impact resistance materials and fine surface treatment with the function of waterproof, dustproof and corrosion resistance;
9. Small volume, light weight, various carrying ways like hand-hold, hang on waist and on shoulder.
10. The illuminant includes cold white and warm white. User can choose according to requirement.

**Standards**

Conform to IEC 60598-2-8:2007、GB 3836.1-2010、GB 3836.4-2010、IEC60598-1:2008

Rated voltage		3.7 V	
Rated capacity		4.4 Ah	
Explosion-proof mark		Ex ib IIC T4 Gb	
Rated power		3 W	
Light source	Rated working voltage	3.7 V	
	Highlight	330 lm	
	Working light	110 lm	
	Average service life	Luminous flux	>100000 h
Continuous discharge time	Highlight	4 h	
	Working light	15 h	
Charging time		≤10 h	
Battery life span		500 circulations	
Working environment temperature		-20 ~ 40 °C	
Overall dimension		186x118x70 mm	
Weight		0.65 Kg	
Protection class		IP66	

dCTH202- dCZH202-

EXPLOSION-PROOF PLUG, SOCKET

dCTH202-3 patent No.: ZL2006 3010 3643.3

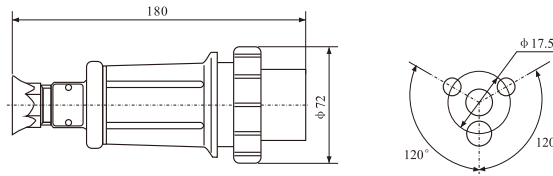
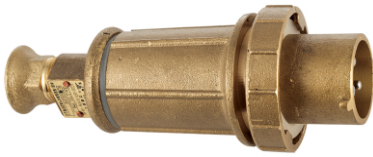

dCZH202- patent No.: ZL2006 3010 3654.3

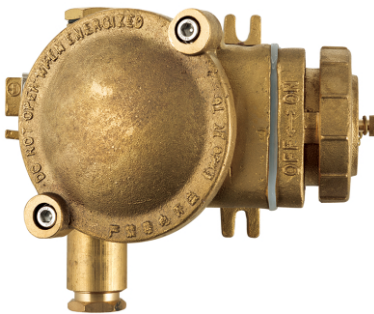

**The scope of application**

Fit for electric appliances connecting and circuit breaking in ships, sea petroleum, chemical industry site ect.

**Products characteristic**

The body adopts precision brass casting , it has the feature of fine sealing function and fine electric function.

**Production authentication**

This series of products have passed the Examination of National Explosionproof Electrical Test Center, and was approved by CCS (China classification society)

**Adopt standard**

IEC60079

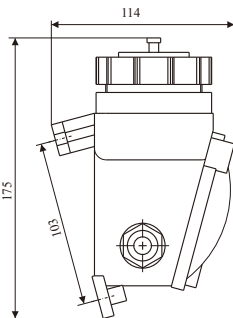
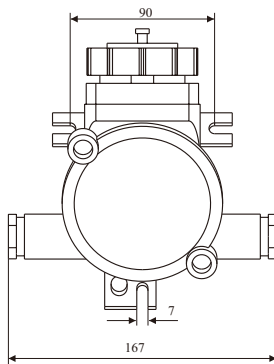

	Explosion-proof Socket			Explosion-proof Plug
	5516/L	5516/R	5516/D	14105/2
code	5516/L	5516/R	5516/D	14105/2
type	dCZH202-1	dCZH202-2	dCZH202-3	dCTH202-3
Product form	O-	-O	-O-	
Voltage	250V/16A			250V/16A
Explosion-proof mark	Exde II C T6			Exe II T6
Protection class	IP56			
Material	brass			
Cable outside Diameter	φ 10- φ 12.5			
weight	2.6kg	2.6kg	2.7kg	1.25kg



## EXPLOSION-PROOF JUNCTION BOX

# dCJXH202-

**The scope of application:** Fit for electric appliances connecting and circuit breaking in ships, sea petroleum, chemical industry site ect.

**Products characteristic:** The body adopts precision brass casting , it has the feature of fine sealing function and fine electric function.

**Production authentication:** This series of products have passed the Examination of National Explosionproof Electrical Test Center, and was approved by CCS (China classification society)

**Adopt standard:** IEC60079

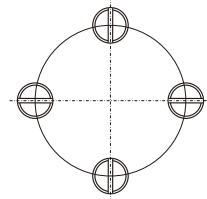
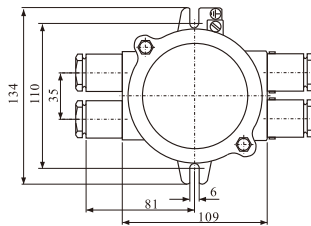
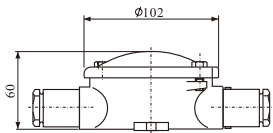

code	510	510/2	510/3	510/4
type	dCJXH202-1	dCJXH202-2	dCJXH202-3	dCJXH202-4
Product form	—○—	○=	—○=	=○=
Voltage	250V/16A			
Explosion-proof mark	Exde II C T6			
Protection class	IP56			
Material	brass			
Cable outside Diameter	φ 10— φ 12.5			
weight	1.4kg	1.4kg	1.5kg	1.5kg

## EXPLOSION-PROOF SWITCH

# dCHH202-

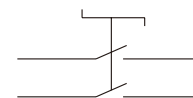
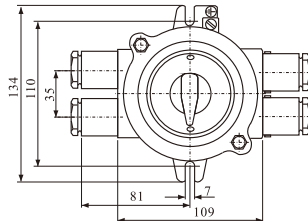
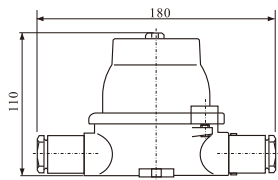

Wiring diagram

code	14105/2	14105/D	14105/3	14105/4
type	dCHH202-2	dCHH202-2A	dCHH202-3	dCHH202-4
Product form	○=	—○—	—○=	=○=
Voltage	380V/16A			
Explosion-proof mark	Exde II C T6			
Protection class	IP56			
Material	brass			
Cable outside Diameter	φ 10— φ 12.5			
weight	2.25kg	2.25kg	2.27kg	2.35kg



## CTHE-3

### AIRTIGHT EXPLOSION-PROOF PLUG

#### The scope of application

Applies to ships, oil platforms, chemical containing II A, II B, II C, T1 to T6 group explosive gas mixtures 1 and Zone 2 place.

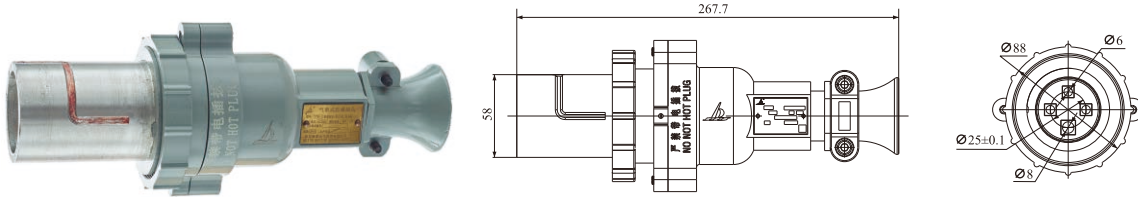

Voltage: AC250V  
Current: 32A  
Protection Class: IP56  
Standard: QJ/HX-S0325-2015 (Airtight explosion-proof plug)  
Explosion-proof mark: Exde IIB+H2 T6 Gb

## CZHE-3

### AIRTIGHT EXPLOSION-PROOF SWITCH WITH SOCKET

#### The scope of application

Applies to ships, oil platforms, chemical containing II A, II B, II C, T1 to T6 group explosive gas mixtures 1 and Zone 2 place.

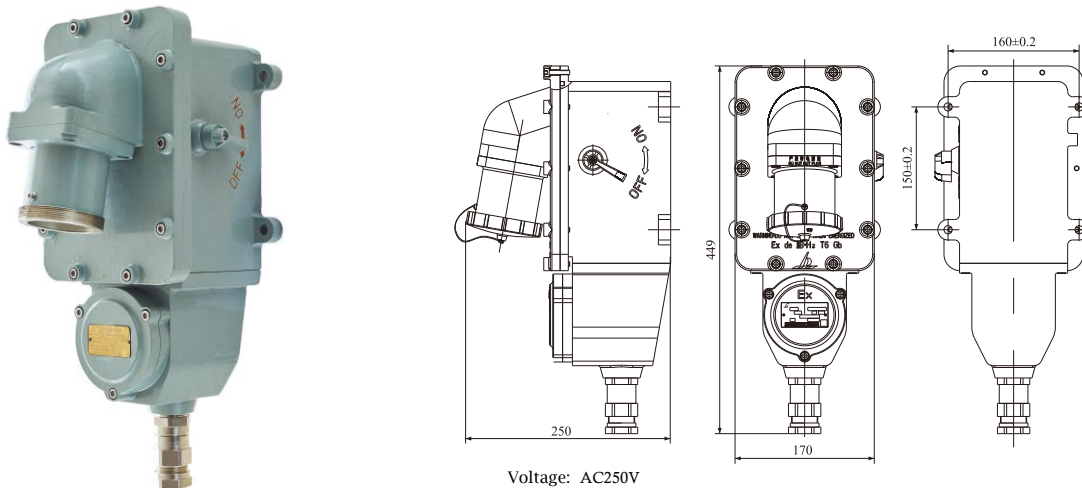

Voltage: AC250V  
Current: 32A  
Protection Class: IP56  
Standard: QJ/HX-S0325-2015 (Airtight explosion-proof switch with socket)  
Explosion-proof mark: Exde IIB+H2 T6 Gb



**EXPLOSION-PROOF BUTTON BOX**
**The scope of application**

Applies to ships, oil platforms, chemical containing II A, II B, T1 to T6 group explosive gas mixtures 1 and Zone 2 place.

**Products characteristic**

1. Product shell is made of the AlSi12 aluminum alloy die-casting, surface electrostatic spray, stainless steel exposed fasteners.
2. Overall enclosure with explosion-proof structure, highly waterproof, dust-proof ability, button box seals are made of silicone rubber, its high corrosion resistance, built-in indicator, two buttons, optional according to customer requirements 1 -2 indicator or the 1-2 buttons; button contact is a normally open a normally closed; signs inside and outside the ground, reliable and secure ground.
3. Rated voltage 380V AC, rated current 5A, protection IP56
4. Armored cable wiring, cable diameter  $\phi 13$  to 14mm.

**Production authentication**

Approved by CCS (China classification society)

**Adopt standard**

National standard GB3836.1-2010, GB3836.2-2010.

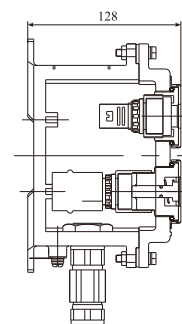
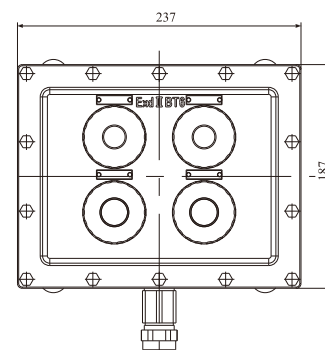
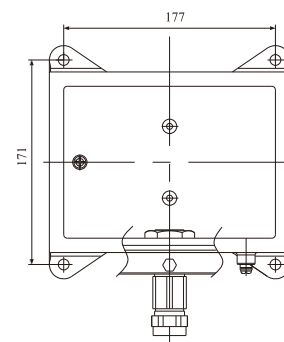

voltage	550V/20A
Explosion-proof mark	Exe II C T6
Protection class	IP56
Material	Aluminum
Cable outside Diameter	$\phi 10 - \phi 12.5$

**Explosion gland**
**Unarmored cable**

Screw thread specification	Wire diameter specification	Protection class
M20X1.5	$\phi 11-14.3$	IP66/68
M25X1.5	$\phi 13-20.2$	
M32X1.5	$\phi 19-26.5$	
M40X1.5	$\phi 25-32.5$	

**Armored cable**

Screw thread specification	Inside Diameter	Outside Diameter	Protection class
M20X1.5	$\phi 11-14.3$	$\phi 13-20.2$	IP66/68
M20X1.5	$\phi 8-11$	$\phi 12-17$	
M25X1.5	$\phi 13-20.2$	$\phi 19-26.5$	
M25X1.5	$\phi 12-17$	$\phi 17-22$	
M32X1.5	$\phi 19-26.5$	$\phi 25-32.5$	
M32X1.5	$\phi 17-22$	$\phi 23-28$	
M40X1.5	$\phi 25-32.5$	$\phi 31.5-42.3$	
M40X1.5	$\phi 23-28$	$\phi 30-37$	

# JXD8-4

## EXPLOSION-PROOF JUNCTION BOX

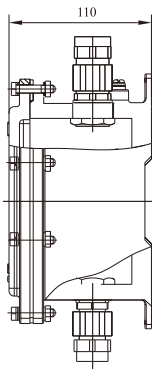
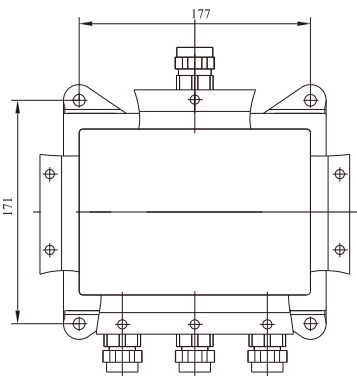
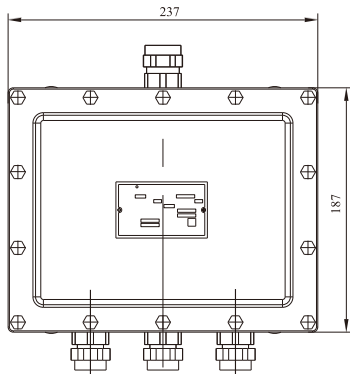

### The scope of application

Applies to ships, oil platforms, chemical containing II A, II B, T1 to T6 group explosive gas mixtures 1 and Zone 2 place.

### Products characteristic

1. The body is made of high quality aluminum die-casting molding, using M22 x 1.5 thread.
2. Sealed structure, protective properties.

### Note

The in let EX-proof cable gland is one, and outlet EX-proof cable gland can be three or less.

Electrical current	20A
voltage	AC 380V
Explosion-proof mark	Exd II B T6 Gb
Protection class	IP56
Material	Cast aluminum alloy

### Explosion gland

Unarmored cable			
Screw thread specification	Wire diameter specification	Protection class	
M20X1.5	Φ11-14.3	IP66/68	
M25X1.5	Φ13-20.2		
M32X1.5	Φ19-26.5		
M40X1.5	Φ25-32.5		
Armored cable			
Screw thread specification	Inside Diameter	Outside Diameter	Protection class
M20X1.5	Φ11-14.3	Φ13-20.2	IP66/68
M20X1.5	Φ8-11	Φ12-17	
M25X1.5	Φ13-20.2	Φ19-26.5	
M25X1.5	Φ12-17	Φ17-22	
M32X1.5	Φ19-26.5	Φ25-32.5	
M32X1.5	Φ17-22	Φ23-28	
M40X1.5	Φ25-32.5	Φ31.5-42.3	
M40X1.5	Φ23-28	Φ30-37	





**The scope of application**

Applied to the place of containing hydrogen gas and air mixture, acetylene gas and air mixture, and the other containing a flammable gas mixture zones 1-2 dangerous places alarm.

**Products characteristic**

1. The body is made of high quality aluminum die-casting molding, using M22 x 1.5 thread;
2. Sealed structure, protective properties.

**Production authentication**

Approved by CCS (China classification society)

**Adopt standard**

Conform to GRADE ENTRY NORMS FOR STEEL SHIPS and National standard GB3836-2010.

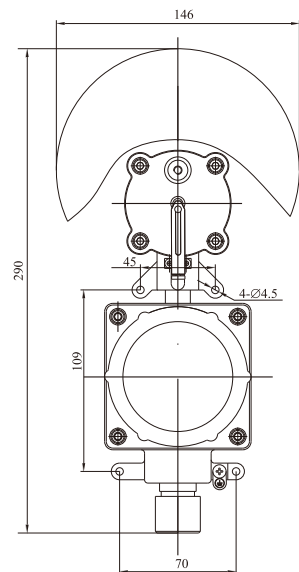

Type	CFBLD-24Z	CFBLD-220J
Voltage	DC 24V	AC 220V
Explosion-proof mark	Exd II CT6 Gb	
Protection class	IP56	
Cable outside diameter	φ 8- φ 11	
Material	Cast aluminum alloy	

